

**BEVERAGE & FOOD
PACKAGING SOLUTIONS
TO MEET YOUR NEEDS**



2026 PRODUCT CATALOG

WWW.EATERYESSENTIALS.COM

INNOVATIVE DISPOSABLE PACKAGING SOLUTION FOR EVERY OCCASION

EATERY ESSENTIALS

is focused on providing high quality, competitively priced plastic foodservice disposables to customers in the following channels: QSR, Cash & Carry, Distribution, Food Processors, Hospitality, Airlines, Entertainment, Supermarket/Grocery and C-Stores.

2425 W Daniieldale Rd., Dallas, TX 75237

Square Feet: 399,971

Office Finish: 19,396



Eatery Essentials is a vertically integrated manufacturer specializing in extrusion and thermoforming of polymer-based drink cups, food containers, and tamper-evident packaging solutions. Combined facilities and warehousing in excess of 2MM sq. ft.

CERTIFICATION & CAPABILITIES

Certifications make us
Global Food Safety Initiative
(GFSI) certified.

FSSC-22000

FSSC-22000

BRC

SQF



2 PROGRESSIVE IN-LINE (extrusion and thermoforming) lines comprising all the operational components to transform raw polymers into finished products.

14 EXTRUDERS with monthly capacity of 400 tons each of PET.

26 HIGH-SPEED THERMOFORMERS producing PET, PLA, and PP cups and containers, delivering total capacity exceeding 200 million units per month.

FACILITIES

CUPS & CONTAINERS
PET, RPET, PLA, & PP

INDEX

PAGE NO.

TAMPER EVIDENT CONTAINER SERIES

- 05 TAMPER EVIDENT HINGED LID CONTAINERS
- 07 TAMPER EVIDENT HINGED COMPARTMENT CONTAINERS
- 08 AUTO CLOSING MACHINE
- 09 TAMPER EVIDENT 7X6" HINGED LID CONTAINERS
- 10 GRAB AND GO - HOAGIES, SANDWICH, WRAPS, & SNACK CONTAINERS
- 11 TAMPER EVIDENT HINGED LID PARFAIT CUPS

TAMPER EVIDENT SQUARE AND ROUND BOWLS

- 12 TAMPER EVIDENT SQUARE BOWLS
- 15 TAMPER EVIDENT HINGED LID ROUND BOWLS

SQUARE DELI & SQUARE 1, 2, 4 CELLS

- 16 TAMPER EVIDENT 8.5X8" 2C BULK & SQUARE DELI CONTAINERS
- 17 TAMPER EVIDENT 6X6" SQUARE 1, 2, & 4 CELL SERIES

PET CONTAINERS

- 18 RPET HINGED LID DELI CONTAINERS
- 19 PET CLEAR SALAD BOWLS
- 20 RPET 2-COMPARTMENT CONTAINER WITH 2 SINGLE-COMPARTMENT LIDS

FILM SEAL & BUTTER LETTUCE

- 20 PET FILM SEAL CONTAINERS
- 22 LEAFY GREENS
- 23 PET BUTTER LETTUCE SINGLE & DOUBLE HINGED CONTAINERS

CATERING TRAYS AND PLATTERS

- 24 PLATTERS
- 25 PET CAKE & BAKERY CONTAINERS
- 27 PET CLEAR ROUND DELI CONTAINERS

PET CLEAR CUP & LIDS

PLA CLEAR CUP & LIDS

CUSTOM PRINTING



TAMPER EVIDENT CONTAINER SERIES

BUT-N-LOC®

 PATENTED BUTTON LOCK DESIGN

- ◆ Original innovators of the button-lock design
- ◆ Only tamper-evident solution compatible with both one-piece hinged and two-piece containers
- ◆ No sharp edges; eliminates wasteful tear strips
- ◆ Available in post-consumer recycled (PCR) PET
- ◆ High clarity with a secure, leak-resistant lid fit

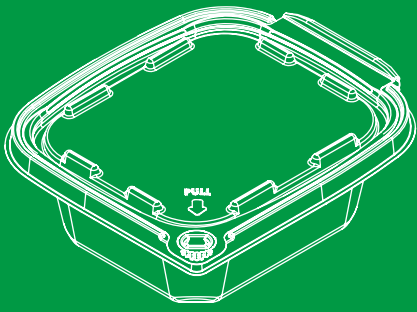

HINGED LID TYPE

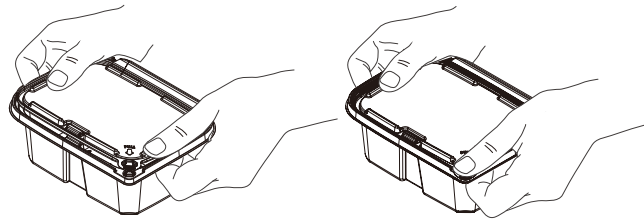

CLOSE THE LID

PUSH TO "LOC" BUTTON

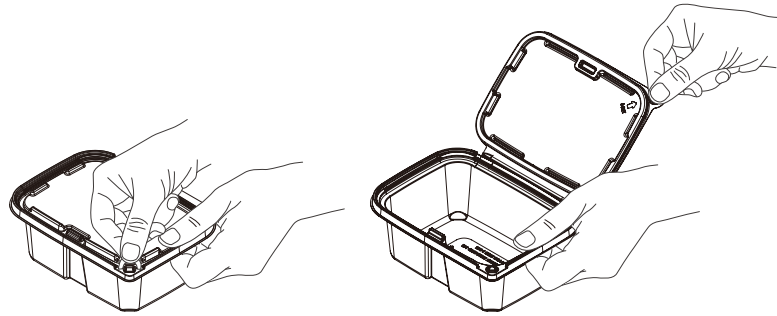

PULL THE TAB, BUTTON REMAINS

OPEN THE LID

 PATENTED BUTTON LOCK DESIGN

BUT-N-LOC®

The innovative tamper-resistant locking mechanism and seal ensures quality and eliminates the need for shrink bands and wrap labels.

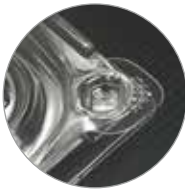

LOCKED



OPENED



NO LEAK LID

The button "Loc" tab fastens to the top of the base. If tampered with prior to purchase the **BUT-N-LOC®** button will not be connected to the tab and a clean hole in the tab will be evident. The engineered tight parameter seal promises a leak resistant experience.

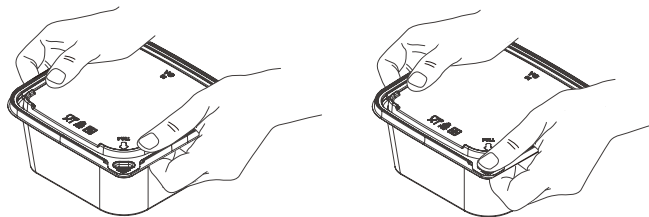

CLOSE THE LID

PUSH TO "LOC" BUTTON

CLOSE & OPEN

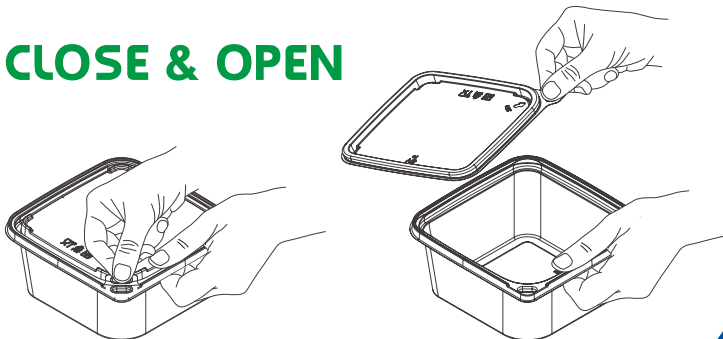

PULL THE TAB, BUTTON REMAINS

OPEN THE LID

2 PIECES TYPE

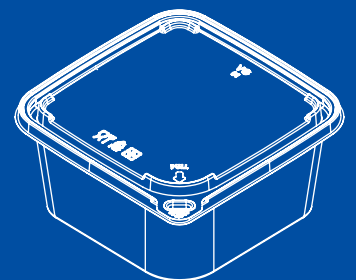

TAMPER EVIDENT HINGED LID CONTAINER



POST CONSUMER RECYCLED PET

These containers available in PET, RPET, Blended RPET and PCR. *Prices vary

Unlike other tamper evident containers that require a plastic tear-off strip, this container has no external pieces to throw away which makes for safer and smoother handling



4oz

RPTTE4AD
4.3 x 3.5 x 1.3
780 PCS / CASE
CASE DIMS. (in)
22.0 x 18.3 x 16.5
3.85 CU.FT.
19.1 LBS
TI X HI / 4 X 5

VENTED



4oz

RPTTE4AD-V
4.3 x 3.5 x 1.3
780 PCS / CASE
CASE DIMS. (in)
22.0 x 18.3 x 16.5
3.85 CU.FT.
19.1 LBS
TI X HI / 4 X 5



6oz

RPTTE6AD
4.3 x 3.5 x 1.7
780 PCS / CASE
CASE DIMS. (in)
22.2 x 18.3 x 17.0
4.00 CU.FT.
24.3 LBS
TI X HI / 4 X 5

VENTED



6oz

RPTTE6AD-V
4.3 x 3.5 x 1.7
780 PCS / CASE
CASE DIMS. (in)
22.2 x 18.3 x 17.0
4.00 CU.FT.
24.3 LBS
TI X HI / 4 X 5



8oz

RPTTE8
5.8 x 5.0 x 1.5
240 PCS / CASE
CASE DIMS. (in)
20.7 x 12.4 x 13.0
1.93 CU.FT.
10.9 LBS
TI X HI / 8 X 7



12oz

RPTTE12
5.8 x 5.0 x 2.0
240 PCS / CASE
CASE DIMS. (in)
20.7 x 12.4 x 13.5
2.00 CU.FT.
11.7 LBS
TI X HI / 8 X 6



12oz SMOOTH WALL

RPTTE12SW
5.8 x 5.0 x 2.0
280 PCS / CASE
CASE DIMS. (in)
24.0 x 16.3 x 10.3
2.31 CU.FT.
13.3 LBS
TI X HI / 5 X 6



16oz

RPTTE16N
5.8 x 5.0 x 2.6
240 PCS / CASE
CASE DIMS. (in)
20.7 x 12.3 x 14.0
2.08 CU.FT.
13.9 LBS
TI X HI / 8 X 6



16oz SMOOTH WALL HEAVY

RPTTE16SWH
5.8 x 5.0 x 2.6
280 PCS / CASE
CASE DIMS. (in)
23.6 x 15.4 x 11.0
2.31 CU.FT.
17.0 LBS
TI X HI / 5 X 8



16oz SMOOTH WALL HEAVY

RPTTE16SWHV
5.8 x 5.0 x 2.6
280 PCS / CASE
CASE DIMS. (in)
23.6 x 15.4 x 11.0
2.31 CU.FT.
17.0 LBS
TI X HI / 5 X 8



16oz TEAR OFF LID

RPTTE16TOL
5.8 x 5.0 x 2.6
240 PCS / CASE
CASE DIMS. (in)
23.6 x 15.4 x 11.0
2.31 CU.FT.
13.9 LBS
TI X HI / 5 X 8

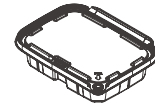

20oz

RPTTE20N
7.4 x 5.7 x 1.8
200 PCS / CASE
CASE DIMS. (in)
15.0 x 12.3 x 20.3
2.17 CU.FT.
16.2 LBS
TI X HI / 11 X 4



20oz SMOOTH WALL

RPTTE20NSW-V
7.4 x 5.6 x 1.8
220 PCS / CASE
CASE DIMS. (in)
23.8 x 15.6 x 12.8
2.74 CU.FT.
17.6 LBS
TI X HI / 5 X 7

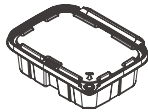

24oz

RPTTE24
7.4 x 5.6 x 2.3
200 PCS / CASE
CASE DIMS. (in)
15.0 x 12.3 x 20.8
2.21 CU.FT.
17.6 LBS
TI X HI / 11 X 4

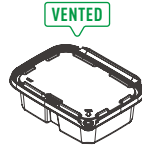

24oz SMOOTH WALL

RPTTE24SW-V
7.4 x 5.6 x 2.3
240 PCS / CASE
CASE DIMS. (in)
23.6 x 15.6 x 13.4
2.84 CU.FT.
20.7 LBS
TI X HI / 5 X 7

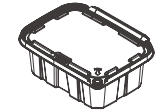

32oz

RPTTE32
7.4 x 5.6 x 2.7
200 PCS / CASE
CASE DIMS. (in)
15.0 x 12.3 x 21.3
2.26 CU.FT.
19.0 LBS
TI X HI / 11 X 4

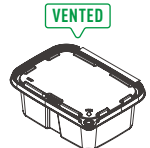

32oz SMOOTH WALL

RPTTE32SW-V
7.4 x 5.7 x 2.7
240 PCS / CASE
CASE DIMS. (in)
23.6 x 15.6 x 14.0
2.97 CU.FT.
22.3 LBS
TI X HI / 5 X 6

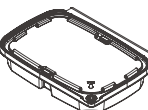

24oz SMOOTH WALL

RPTTE2P24SW
8.3 x 6.0 x 1.7
342 PCS / CASE
CASE DIMS. (in)
25.4 x 12.6 x 22.7
4.19 CU.FT.
31.6 LBS
TI X HI / 6 X 4

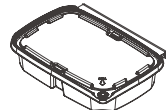

28oz SMOOTH WALL

RPTTE2P28SW
8.3 x 6.0 x 1.9
336 PCS / CASE
CASE DIMS. (in)
25.4 x 12.6 x 22.6
4.18 CU.FT.
33.3 LBS
TI X HI / 6 X 4



35oz SMOOTH WALL

RPTTE35SW
8.8 x 7.9 x 1.8
180 PCS / CASE
CASE DIMS. (in)
18.3 x 16.8 x 18.1
3.21 CU.FT.
24.0 LBS
TI X HI / 6 X 5

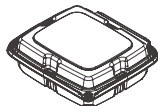

35oz

RPTTE35DL
8.8 x 7.9 x 2.6
180 PCS / CASE
CASE DIMS. (in)
17.5 x 17.1 x 18.2
3.14 CU.FT.
23.8 LBS
TI X HI / 6 X 5

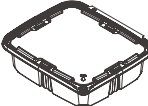

48oz SMOOTH WALL

RPTTE48SW
8.8 x 7.9 x 2.4
176 PCS / CASE
CASE DIMS. (in)
17.8 x 17.0 x 18.0
3.15 CU.FT.
25.1 LBS
TI X HI / 6 X 5

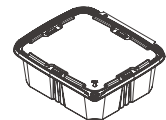

64oz SMOOTH WALL

RPTTE64SW
8.8 x 7.9 x 3.0
164 PCS / CASE
CASE DIMS. (in)
18.6 x 16.9 x 18.2
3.31 CU.FT.
27.5 LBS
TI X HI / 6 X 5

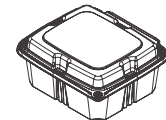

64oz

RPTTE64DL
8.8 x 7.9 x 3.8
164 PCS / CASE
CASE DIMS. (in)
18.6 x 16.9 x 18.2
3.31 CU.FT.
27.5 LBS
TI X HI / 6 X 5



TAMPER EVIDENT HINGED COMPARTMENT CONTAINERS



16oz 4 cell
3.1oz x 4

RPTTE16SP4C
7.4 x 5.6 x 1.5
460 PCS / CASE
CASE DIMS. (in)
24.0 x 15.4 x 23.0
4.92 CU.FT.
38.5 LBS
TI X HI / 5 X 4

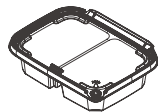

20oz 2 comp.
9.3oz x 2

RPTTE20-2C
7.4 x 5.7 x 1.8
200 PCS / CASE
CASE DIMS. (in)
23.6 x 15.0 x 12.0
2.46 CU.FT.
17.7 LBS
TI X HI / 5 X 7



20oz 3 comp.
9.3oz, 4.1oz x 2

RPTTE20-3C
7.4 x 5.7 x 1.8
200 PCS / CASE
CASE DIMS. (in)
23.8 x 15.6 x 12.8
2.74 CU.FT.
17.7 LBS
TI X HI / 5 X 7



20oz 4 comp.
4.1oz x 4

RPTTE20-4C
7.4 x 5.7 x 1.8
200 PCS / CASE
CASE DIMS. (in)
23.8 x 15.6 x 12.8
2.74 CU.FT.
17.7 LBS
TI X HI / 5 X 7

TAMPER EVIDENT 6.5X6.5 RPET HINGED LID CONTAINER

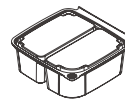

2 CELL
16.7oz, 17.0oz

RPTTE6565-32-2C
6.7 x 6.7 x 2.5
195 PCS / CASE
CASE DIMS. (in)
24.4 x 13.7 x 21.5
4.14 CU.FT.
23.8 LBS
TI X HI / 6 X 4

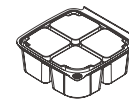

4 CELL
7.5oz, 7.9oz x 3

RPTTE6565-32-4C
6.7 x 6.7 x 2.5
195 PCS / CASE
CASE DIMS. (in)
24.4 x 13.7 x 21.5
4.14 CU.FT.
23.8 LBS
TI X HI / 6 X 4



DESIGNED FOR
TAMPER EVIDENT
HINGED LID CONTAINERS

CLOSING MACHINE



IDEAL DESIGN FOR
FRESH PRODUCE
PACKAGING



ACCELERATES
AND SIMPLIFIES
CLOSING PROCESS



COMPACT, EASY TO USE,
CLEAN AND MAINTAIN

VPA200

SIZE (in) : 77.8 x 39.3 x 41.5

WEIGHT (lb) : 330.7

CASE DIMS. (in) 85.8 x 47.2 x 54.7

CASE. G.W.(lb) : 551.2

Automatic closing machine is designed specifically for our patented **BUT-N-LOC®** tamper evident hinged lid containers, operates with sizes 8oz to 64oz, and processes up to 80 containers per minute. Sturdy aluminum and steel construction with electronic control system for flexible ease of use operation.

Our machine increases productivity through reduced labor costs, improved reliability and output. Ideal secure packaging system for a wide variety of fresh food products, automatic closing machines are as efficient as they are effective.



TAMPER EVIDENT 7X6" HINGED LID CONTAINERS



16oz

RPTTE76-16
7.1 x 6.4 x 1.3
348 PCS / CASE
CASE DIMS. (in)
21.9 x 13.4 x 22.7
3.85 CU.FT.
25.8 LBS
TI X HI / 6 X 4



24oz

RPTTE76-24H
7.1 x 6.4 x 1.9
339 PCS / CASE
CASE DIMS. (in)
21.9 x 13.4 x 22.7
3.85 CU.FT.
30.2 LBS
TI X HI / 6 X 4



24oz

RPTTE76-24HTV
7.1 x 6.4 x 2.1
339 PCS / CASE
CASE DIMS. (in)
21.9 x 13.4 x 22.7
3.85 CU.FT.
27.6 LBS
TI X HI / 6 X 4



32oz

RPTTE76-32H
7.1 x 6.4 x 2.6
315 PCS / CASE
CASE DIMS. (in)
21.9 x 13.4 x 22.8
3.88 CU.FT.
31.7 LBS
TI X HI / 6 X 4



32oz

RPTTE76-32HV
7.1 x 6.4 x 2.6
315 PCS / CASE
CASE DIMS. (in)
21.9 x 13.4 x 22.8
3.87 CU.FT.
31.7 LBS
TI X HI / 6 X 4

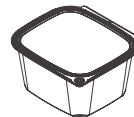

48oz JUICE SEPARATOR

RPTTE76-48JSV
7.1 x 6.4 x 3.5
196 PCS / CASE
CASE DIMS. (in)
14.8 x 13.4 x 23.4
2.69 CU.FT.
28.1 LBS
TI X HI / 9 X 4

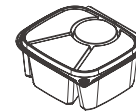

TALL 4 comp. 5.7oz, 9.7oz x 3

RPTTE76-4CTV
7.1 x 6.4 x 2.8
264 PCS / CASE
CASE DIMS. (in)
21.9 x 13.4 x 23.4
3.97 CU.FT.
38.3 LBS
TI X HI / 6 X 3

GRAB & GO ITEMS!

HOAGIE CONTAINER

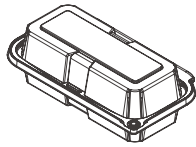

RPTTEHG
9.1 x 4.9 x 2.9
232 PCS / CASE
CASE DIMS. (in)
21.2 x 18.7 x 15.1
3.47 CU.FT.
20.9 LBS
TI X HI / 4 X 6

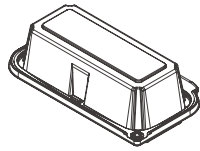

RPTTEHG-8R
9.1 x 5.1 x 2.9
222 PCS / CASE
CASE DIMS. (in)
21.3 x 9.7 x 21.8
2.69 CU.FT.
20.1 LBS
TI X HI / 9 X 4



SANDWICH WEDGE & WRAP

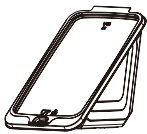

RPTTESW
5.6 x 4.0 x 5.1
250 PCS / CASE
CASE DIMS. (in)
20.7 x 15.6 x 14.2
2.64 CU.FT.
16.0 LBS
TI X HI / 6 x 6



RPTTEWR
6.1 x 6.0 x 2.0
231 PCS / CASE
CASE DIMS. (in)
19.2 x 13.7 x 18.1
2.75 CU.FT.
20.3 LBS
TI X HI / 6 x 5



LARGE SANDWICH
RPTTEHSL
5.7 x 4.6 x 3.6
400 PCS / CASE
CASE DIMS. (in)
19.1 x 14.3 x 22.6
3.57 CU.FT.
31.3 LBS
TI X HI / 6 x 4



SMALL SANDWICH
RPTTEHSS
5.3 x 4.5 x 2.3
455 PCS / CASE
CASE DIMS. (in)
22.9 x 13.1 x 23.1
4.02 CU.FT.
27.3 LBS
TI X HI / 6 x 4

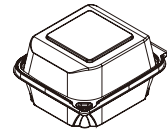

RPTTESWR3S
6.0 x 5.1 x 3.5
522 PCS / CASE
CASE DIMS. (in)
24.8 x 15.9 x 18.1
4.15 CU.FT.
28.7 LBS
TI X HI / 4 x 5

SMALL WRAP & SNACK CONTAINERS



RPTTESWR
5.6 x 5.1 x 2.2
522 PCS / CASE
CASE DIMS. (in)
24.8 x 15.9 x 18.7
4.28 CU.FT.
40.2 LBS
TI X HI / 5 x 5

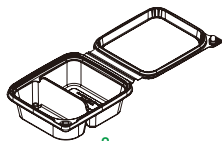

2 comp.
4.8oz, 7.5oz
RPTTESWR-2C
6.1 x 5.1 x 2.0
330 PCS / CASE
CASE DIMS. (in)
15.9 x 12.7 x 22.1
2.59 CU.FT.
22.6 LBS
TI X HI / 9 x 4

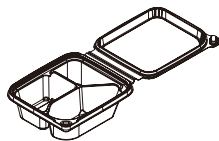

3 comp.
3.4oz, 3.9oz x 2
RPTTESWR-3C
6.1 x 5.1 x 2.0
330 PCS / CASE
CASE DIMS. (in)
15.9 x 12.7 x 22.3
2.61 CU.FT.
22.6 LBS
TI X HI / 9 x 4

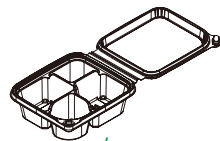

4 comp.
2.4oz, 3.4oz, 3.5oz, 2.0oz
RPTTESWR-4C
6.1 x 5.1 x 2.0
330 PCS / CASE
CASE DIMS. (in)
15.9 x 12.7 x 22.1
2.59 CU.FT.
22.6 LBS
TI X HI / 9 x 4

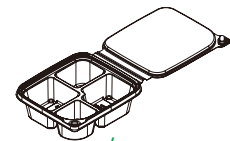

4 comp.
2.4oz, 3.4oz, 3.5oz, 2.0oz
RPTTESWR-R4C
6.0 x 5.1 x 1.7
330 PCS / CASE
CASE DIMS. (in)
15.9 x 12.7 x 22.0
2.58 CU.FT.
22.6 LBS
TI X HI / 9 x 4



TAMPER EVIDENT HINGED LID PARFAIT CUPS

These cups are suitable for cut fruit, cut veggies, brownie bites, cookies, yogurt parfaits, and other snacks.

Tight lid fit prevents spills - in the store and on the go - and helps maintain product freshness.

2 types insert options fits all cups. The new flat panel design makes it easy to apply a scale label and have it lay flat.



9oz

RPTTEFPC-09
4.4 x 3.9 x 2.8
500 PCS / CASE
CASE DIMS. (in)
22.8 x 16.7 x 15.2
3.35 CU.FT.
24.7 LBS
TI X HI / 5 x 5



11oz

RPTTEFPC-11
4.4 x 3.9 x 3.5
500 PCS / CASE
CASE DIMS. (in)
22.8 x 16.7 x 16.1
3.57 CU.FT.
28.4 LBS
TI X HI / 5 x 5



13oz

RPTTEFPC-13
4.4 x 3.9 x 4.2
450 PCS / CASE
CASE DIMS. (in)
22.8 x 16.7 x 15.7
3.48 CU.FT.
21.6 LBS
TI X HI / 5 x 5

VENTED



9oz

RPTTEFPC-09V
4.4 x 3.9 x 2.8
500 PCS / CASE
CASE DIMS. (in)
22.8 x 16.7 x 15.2
3.35 CU.FT.
24.7 LBS
TI X HI / 5 x 5

VENTED



11oz

RPTTEFPC-11V
4.4 x 3.9 x 3.5
500 PCS / CASE
CASE DIMS. (in)
22.8 x 16.7 x 16.1
3.57 CU.FT.
28.4 LBS
TI X HI / 5 x 5

VENTED



13oz

RPTTEFPC-13V
4.4 x 3.9 x 4.2
450 PCS / CASE
CASE DIMS. (in)
22.8 x 16.7 x 15.7
3.48 CU.FT.
21.6 LBS
TI X HI / 5 x 5



3oz INSERT

RPTTEFPC-INS
3.7 x 3.2 x 1.2
1200 PCS / CASE
CASE DIMS. (in)
19.7 x 15.4 x 12.0
2.10 CU.FT.
12.8 LBS
TI X HI / 6 x 7



4oz INSERT

RPTTEFPC-IN
3.7 x 3.2 x 1.4
1200 PCS / CASE
CASE DIMS. (in)
19.7 x 15.4 x 12.4
2.18 CU.FT.
14.0 LBS
TI X HI / 6 x 7



4oz INSERT 2C

RPTTEFPC-IN2
3.7 x 3.2 x 1.4
1200 PCS / CASE
CASE DIMS. (in)
19.7 x 15.4 x 12.4
2.18 CU.FT.
16.7 LBS
TI X HI / 6 x 7



TAMPER EVIDENT SQUARE BOWLS

BUT-N-LOC® branded PET Tamper Evident Square Bowls are ideal for processors, supermarkets, wholesale clubs, and C-stores. Crystal clear lids, crack resistant and leak resistant bowls to ensure safe and stable handling. Black or color bases also available.

5.0"
127mm Dia.

Available in four footprints, 5", 6.5", 7.5", and 9". Each footprint available in a variety of capacities and compartments. The stackability of these square bowls may improve your shelf space utilization.



8oz

PTTESB5-08B
5.0 x 5.0 x 1.6
600 PCS / CASE
CASE DIMS. (in)
20.7 x 15.6 x 15.6
2.89 CU.FT.
16.1 LBS
TIX HI / 5 X 5



12oz

PTTESB5-12B
5.0 x 5.0 x 2.2
600 PCS / CASE
CASE DIMS. (in)
20.7 x 15.6 x 15.7
2.93 CU.FT.
17.4 LBS
TIX HI / 5 X 5



16oz

PTTESB5-16B
5.0 x 5.0 x 2.9
600 PCS / CASE
CASE DIMS. (in)
20.7 x 15.6 x 16.9
3.15 CU.FT.
20.1 LBS
TIX HI / 5 X 5



FLAT LID

PTTESBFLID5B
5.0 x 5.0 x 0.3
600 PCS / CASE
CASE DIMS. (in)
19.5 x 14.8 x 13.8
2.29 CU.FT.
15.2 LBS
TIX HI / 6 X 6



DOME LID

PTTESBDLID5B
5.0 x 5.0 x 0.8
600 PCS / CASE
CASE DIMS. (in)
19.5 x 14.8 x 13.4
2.23 CU.FT.
15.1 LBS
TIX HI / 5 X 6

6.5"
165mm Dia.



18oz

PTTESB65-18B
6.5 x 6.5 x 1.9
720 PCS / CASE
CASE DIMS. (in)
33.1 x 13.6 x 21.7
5.63 CU.FT.
26.0 LBS
TI X HI / 4 X 4



24oz

PTTESB65-24B
6.5 x 6.5 x 2.5
720 PCS / CASE
CASE DIMS. (in)
33.1 x 13.6 x 22.2
5.77 CU.FT.
28.4 LBS
TI X HI / 4 X 4



32oz

PTTESB65-32B
6.5 x 6.5 x 3.4
720 PCS / CASE
CASE DIMS. (in)
33.1 x 13.6 x 23.1
6.02 CU.FT.
30.8 LBS
TI X HI / 4 X 4



48oz

PTTESB65-48B
6.5 x 6.5 x 4.6
720 PCS / CASE
CASE DIMS. (in)
33.1 x 13.6 x 24.3
6.31 CU.FT.
45.9 LBS
TI X HI / 4 X 4

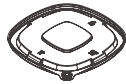

FLAT LID

PTTESBFLID65B
6.1 x 6.1 x 0.5
360 PCS / CASE
CASE DIMS. (in)
18.9 x 18.9 x 11.7
2.42 CU.FT.
14.7 LBS
TI X HI / 4 X 7



DOME LID

PTTESBDLID65B
6.1 x 6.1 x 1.0
360 PCS / CASE
CASE DIMS. (in)
18.9 x 18.9 x 12.2
2.53 CU.FT.
14.7 LBS
TI X HI / 4 X 7

7.5"
191mm Dia.



18oz

PTTESB75-18B
7.5 x 7.5 x 1.6
300 PCS / CASE
CASE DIMS. (in)
23.6 x 15.9 x 14.2
3.09 CU.FT.
15.4 LBS
TI X HI / 5 X 6

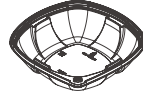

24oz

PTTESB75-24B
7.5 x 7.5 x 1.9
300 PCS / CASE
CASE DIMS. (in)
23.6 x 15.9 x 15.4
3.35 CU.FT.
16.8 LBS
TI X HI / 5 X 6



24oz 4 COMP.

PTTESB75-24B-4C
7.5 x 7.5 x 1.9
300 PCS / CASE
CASE DIMS. (in)
23.6 x 15.9 x 15.4
3.35 CU.FT.
17.0 LBS
TI X HI / 5 X 6

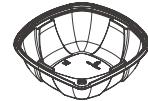

32oz

PTTESB75-32B
7.5 x 7.5 x 2.4
300 PCS / CASE
CASE DIMS. (in)
23.6 x 15.9 x 15.7
3.43 CU.FT.
17.4 LBS
TI X HI / 5 X 6



48oz

PTTESB75-48B
7.5 x 7.5 x 3.4
300 PCS / CASE
CASE DIMS. (in)
23.6 x 15.9 x 17.1
3.73 CU.FT.
19.8 LBS
TI X HI / 5 X 6

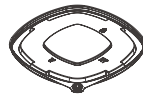

FLAT LID

PTTESBFLID75B
7.1 x 7.1 x 0.4
300 PCS / CASE
CASE DIMS. (in)
22.2 x 15.2 x 14.0
2.73 CU.FT.
14.0 LBS
TI X HI / 5 X 6

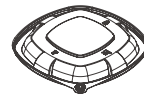

DOME LID

PTTESBDLID75B
7.1 x 7.1 x 1.0
300 PCS / CASE
CASE DIMS. (in)
22.2 x 15.2 x 13.8
2.69 CU.FT.
14.0 LBS
TI X HI / 5 X 6

9.0"
229mm Dia.

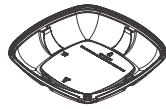

30oz

PTTESB9-30B-N
9.0 x 9.0 x 1.6
180 PCS / CASE
CASE DIMS. (in)
23.6 x 9.6 x 18.0
2.37 CU.FT.
13.9 LBS
TI X HI / 8 X 5

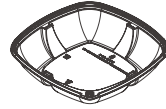

40oz

PTTESB9-40B-N
9.0 x 9.0 x 2.0
180 PCS / CASE
CASE DIMS. (in)
24.2 x 9.7 x 18.4
2.49 CU.FT.
14.3 LBS
TI X HI / 8 X 5

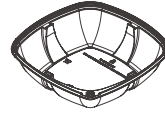

48oz

PTTESB9-48B-N
9.0 x 9.0 x 2.4
180 PCS / CASE
CASE DIMS. (in)
18.9 x 9.8 x 22.2
2.39 CU.FT.
14.9 LBS
TI X HI / 10 X 4



48oz 4 COMP.

PTTESB9-48B-4C
9.0 x 9.0 x 2.4
180 PCS / CASE
CASE DIMS. (in)
18.9 x 9.8 x 22.2
2.39 CU.FT.
14.5 LBS
TI X HI / 10 X 4

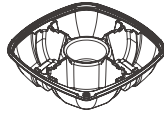

48oz 5 COMP.

PTTESB9-48B-5C
9.0 x 9.0 x 2.4
180 PCS / CASE
CASE DIMS. (in)
18.9 x 9.8 x 22.2
2.38 CU.FT.
15.7 LBS
TI X HI / 10 X 4

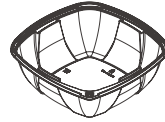

64oz

PTTESB9-64B-N
9.0 x 9.0 x 3.1
180 PCS / CASE
CASE DIMS. (in)
18.5 x 9.6 x 21.9
2.24 CU.FT.
17.3 LBS
TI X HI / 10 X 4

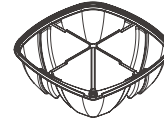

64oz 4 COMP.

PTTESB9-64B-4C-N
9.0 x 9.0 x 3.1
180 PCS / CASE
CASE DIMS. (in)
18.3 x 9.6 x 24.0
2.43 CU.FT.
17.4 LBS
TI X HI / 10 X 4

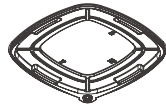

FLAT LID

PTTESBFLID9B
8.6 x 8.6 x 0.5
180 PCS / CASE
CASE DIMS. (in)
18.9 x 9.8 x 18.7
2.01 CU.FT.
13.1 LBS
TI X HI / 10 X 5

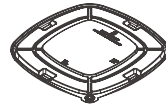

FLAT LID

PTTESBFLID9B-N
8.6 x 8.6 x 0.5
180 PCS / CASE
CASE DIMS. (in)
18.3 x 9.7 x 21.7
2.22 CU.FT.
13.1 LBS
TI X HI / 10 X 4

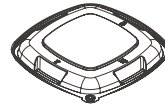

DOME LID

PTTESBDLID9B
8.6 x 8.6 x 1.0
180 PCS / CASE
CASE DIMS. (in)
18.9 x 9.8 x 17.9
1.93 CU.FT.
13.0 LBS
TI X HI / 10 X 5

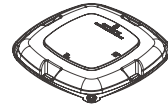

DOME LID

PTTESBDLID9B-N
8.6 x 8.6 x 1.0
180 PCS / CASE
CASE DIMS. (in)
18.3 x 9.6 x 23.6
2.41 CU.FT.
13.6 LBS
TI X HI / 8 X 5

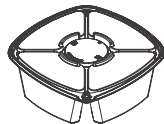

5 COMP. JUICE SEPARATOR

PTTESB9-LG5C2
9.0 x 9.0 x 3.1
180 SETS / CASE
CASE DIMS. (in)
18.3 x 9.7 x 22.2
2.28 CU.FT.
22.4 LBS
TI X HI / 10 X 4

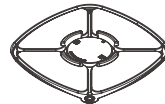

FLAT LID

PTTESBFLID2-9B
8.6 x 8.6 x 0.5
180 PCS / CASE
CASE DIMS. (in)
18.3 x 9.6 x 19.9
2.03 CU.FT.
14.1 LBS
TI X HI / 10 X 4

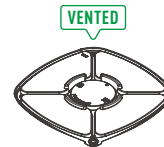

FLAT LID

PTTESBFLID2-9BV
8.6 x 8.6 x 0.5
180 PCS / CASE
CASE DIMS. (in)
17.9 x 9.3 x 19.9
1.91 CU.FT.
14.1 LBS
TI X HI / 10 X 4



TAMPER EVIDENT HINGED LID ROUND BOWLS

POST CONSUMER RECYCLED PET



18oz

RPTTERBM18
7.2 x 7.0 x 2.4
375 PCS / CASE
CASE DIMS. (in)
24.7 x 14.7 x 22.0
4.62 CU.FT.
32.0 LBS
TI X HI / 5 X 4



18oz

RPTTERBM18-V
7.2 x 7.0 x 2.4
375 PCS / CASE
CASE DIMS. (in)
24.7 x 14.7 x 22.0
4.62 CU.FT.
32.0 LBS
TI X HI / 5 X 4



24oz

RPTTERBM24
7.2 x 7.0 x 3.0
363 PCS / CASE
CASE DIMS. (in)
24.7 x 14.7 x 22.0
4.62 CU.FT.
32.6 LBS
TI X HI / 5 X 4



24oz

RPTTERBM24-V
7.2 x 7.0 x 3.0
363 PCS / CASE
CASE DIMS. (in)
24.7 x 14.7 x 22.0
4.62 CU.FT.
32.6 LBS
TI X HI / 5 X 4

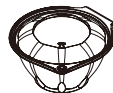

32oz

RPTTERBM32
7.2 x 7.0 x 3.8
351 PCS / CASE
CASE DIMS. (in)
24.7 x 14.7 x 22.0
4.62 CU.FT.
32.8 LBS
TI X HI / 5 X 4



32oz

RPTTERBM32-V
7.2 x 7.0 x 3.8
351 PCS / CASE
CASE DIMS. (in)
24.7 x 14.7 x 22.0
4.62 CU.FT.
32.8 LBS
TI X HI / 5 X 4



40oz

RPTTERBL40
9.6 x 9.7 x 2.6
126 PCS / CASE
CASE DIMS. (in)
19.4 x 16.6 x 19.6
3.65 CU.FT.
21.1 LBS
TI X HI / 6 X 4



40oz

RPTTERBL40-V
9.6 x 9.7 x 2.6
126 PCS / CASE
CASE DIMS. (in)
19.4 x 16.6 x 19.6
3.65 CU.FT.
21.1 LBS
TI X HI / 6 X 4



48oz

RPTTERBL48
9.6 x 9.7 x 2.9
120 PCS / CASE
CASE DIMS. (in)
19.4 x 16.6 x 19.6
3.65 CU.FT.
21.9 LBS
TI X HI / 6 X 4



48oz

RPTTERBL48-V
9.6 x 9.7 x 2.9
120 PCS / CASE
CASE DIMS. (in)
19.4 x 16.6 x 19.6
3.65 CU.FT.
21.9 LBS
TI X HI / 6 X 4



64oz

RPTTERBL64
9.6 x 9.7 x 3.5
108 PCS / CASE
CASE DIMS. (in)
19.4 x 16.6 x 19.6
3.65 CU.FT.
21.7 LBS
TI X HI / 6 X 4



64oz

RPTTERBL64-V
9.6 x 9.7 x 3.5
108 PCS / CASE
CASE DIMS. (in)
19.4 x 16.6 x 19.6
3.65 CU.FT.
21.7 LBS
TI X HI / 6 X 4



80oz

RPTTERBL80
9.6 x 9.7 x 4.0
102 PCS / CASE
CASE DIMS. (in)
19.4 x 16.6 x 19.6
3.65 CU.FT.
21.1 LBS
TI X HI / 6 X 4



80oz

RPTTERBL80-V
9.6 x 9.7 x 4.0
102 PCS / CASE
CASE DIMS. (in)
19.4 x 16.6 x 19.6
3.65 CU.FT.
21.1 LBS
TI X HI / 6 X 4

TAMPER EVIDENT 8.5X8" 2C BULK

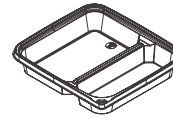

28oz
PTTE858-2C
8.5 x 7.9 x 1.6
136 PCS / CASE
CASE DIMS. (in)
34.9 x 8.7 x 18.1
3.19 CU.FT.
10.2 LBS
TI X HI / 5 X 5



DOME LID
PTTE858-2CLID
8.1 x 7.5 x 0.5
136 PCS / CASE
CASE DIMS. (in)
33.8 x 8.5 x 15.9
2.64 CU.FT.
9.3 LBS
TI X HI / 5 X 5



TAMPER EVIDENT SQUARE DELI CONTAINERS

BUT-N-LOC® branded PET Tamper Evident Square Deli Containers are available in five sizes: 8, 12, 16, 24, and 32oz with one common lid fit for all sizes.

The lid allows for stable stacking to maximize shelf space.

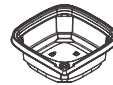

8oz
PTTESDC08
4.8 x 4.8 x 1.8
500 PCS / CASE
CASE DIMS. (in)
24.6 x 10.4 x 13.0
1.93 CU.FT.
15.5 LBS
TI X HI / 6 X 7

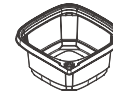

12oz
PTTESDC12
4.8 x 4.8 x 2.3
500 PCS / CASE
CASE DIMS. (in)
24.6 x 10.4 x 14.2
2.10 CU.FT.
20.1 LBS
TI X HI / 6 X 6



16oz
PTTESDC16
4.8 x 4.8 x 3.1
500 PCS / CASE
CASE DIMS. (in)
24.6 x 10.4 x 15.0
2.22 CU.FT.
23.9 LBS
TI X HI / 6 X 6



24oz
PTTESDC24
4.8 x 4.8 x 4.0
500 PCS / CASE
CASE DIMS. (in)
24.6 x 10.4 x 16.9
2.51 CU.FT.
28.4 LBS
TI X HI / 6 X 5



32oz
PTTESDC32
4.8 x 4.8 x 5.2
500 PCS / CASE
CASE DIMS. (in)
24.6 x 10.4 x 19.7
2.92 CU.FT.
37.4 LBS
TI X HI / 6 X 4



LID
PTTESDCLID
4.6 x 4.6 x 0.3
500 PCS / CASE
CASE DIMS. (in)
22.8 x 9.8 x 11.4
1.48 CU.FT.
11.1 LBS
TI X HI / 8 X 8



LID
PTTESDCLID-V
4.6 x 4.6 x 0.3
500 PCS / CASE
CASE DIMS. (in)
22.8 x 9.8 x 11.4
1.48 CU.FT.
11.1 LBS
TI X HI / 8 X 8

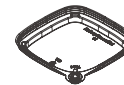

RECESSED LID
PTTESDCRLID
4.6 x 4.6 x 0.6
500 PCS / CASE
CASE DIMS. (in)
22.8 x 9.8 x 11.6
1.51 CU.FT.
11.1 LBS
TI X HI / 8 X 8



RECESSED LID
PTTESDCRLID-V
4.6 x 4.6 x 0.6
500 PCS / CASE
CASE DIMS. (in)
22.8 x 9.8 x 11.6
1.51 CU.FT.
11.1 LBS
TI X HI / 8 X 7



TAMPER EVIDENT 6X6" SQUARE 1, 2, 4 CELL SERIES

Keeps food fresh and separate, helping you to easily separate different foods, ensuring that flavors do not mix, and each food remains fresh.

The lid allows for stable stacking to maximize shelf space.

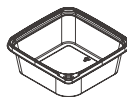

24oz

PTTES66-24
6.1 x 6.1 x 2.2
300 PCS / CASE
CASE DIMS. (in)
19.0 x 12.9 x 15.9
2.26 CU.FT.
14.4 LBS
TI X HI / 7 X 5

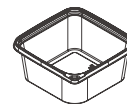

32oz

PTTES66-32
6.1 x 6.1 x 2.8
300 PCS / CASE
CASE DIMS. (in)
19.0 x 12.9 x 16.7
2.36 CU.FT.
16.1 LBS
TI X HI / 7 X 5



60oz

PTTES66-60
6.1 x 6.1 x 5.3
300 PCS / CASE
CASE DIMS. (in)
18.3 x 12.6 x 18.8
2.50 CU.FT.
25.4 LBS
TI X HI / 8 X 5

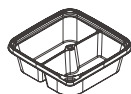

2 CELL

9.7oz, 9.8oz
PTTES66-2C
6.1 x 6.1 x 2.0
300 PCS / CASE
CASE DIMS. (in)
19.0 x 12.9 x 15.7
2.22 CU.FT.
14.4 LBS
TI X HI / 7 X 5

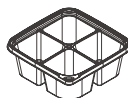

4 CELL

5.5oz x 3, 5.1oz
PTTES66-4C
6.1 x 6.1 x 2.3
300 PCS / CASE
CASE DIMS. (in)
19.0 x 12.9 x 16.3
2.30 CU.FT.
16.1 LBS
TI X HI / 6 X 5



RECESSED LID

PTTES66-RLID
6.0 x 6.0 x 0.3
300 PCS / CASE
CASE DIMS. (in)
17.8 x 12.1 x 14.2
1.77 CU.FT.
13.1 LBS
TI X HI / 8 X 6

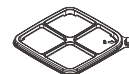

4 CELL LID

PTTES66-4CLID
6.0 x 6.0 x 0.3
300 PCS / CASE
CASE DIMS. (in)
17.8 x 12.1 x 14.2
1.77 CU.FT.
13.1 LBS
TI X HI / 7 X 6

6.0"
152mm Dia.

RPET HINGED LID DELI CONTAINER



**POST CONSUMER
RECYCLED PET**

These containers are available in PET, RPET, Blended RPET, and PCR. ***Prices vary**

One-piece hinged construction and spill-resistant closures. These containers offer enhanced clarity for superior product visibility. Ideal for supermarkets, processors, wholesale clubs, and c-stores.



4oz

RPTHLD4
4.2 x 3.8 x 1.4
400 PCS / CASE
CASE DIMS. (in)
21.7 x 16.1 x 9.4
1.91 CU.FT.
11.9 LBS
TI X HI / 5 X 10



6oz

RPTHLD6
4.2 x 3.8 x 1.9
400 PCS / CASE
CASE DIMS. (in)
22.2 x 16.1 x 9.4
1.96 CU.FT.
13.4 LBS
TI X HI / 5 X 9

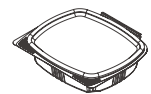

8oz

RPTHLD8
5.6 x 4.9 x 1.4
200 PCS / CASE
CASE DIMS. (in)
17.3 x 10.4 x 12.4
1.30 CU.FT.
8.7 LBS
TI X HI / 9 X 7

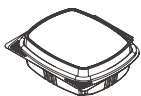

8oz TALL

RPTHLD8T
5.6 x 4.9 x 1.8
200 PCS / CASE
CASE DIMS. (in)
18.9 x 10.4 x 12.4
1.41 CU.FT.
9.6 LBS
TI X HI / 9 X 7

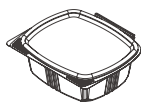

12oz

RPTHLD12
5.6 x 4.9 x 1.9
200 PCS / CASE
CASE DIMS. (in)
17.7 x 10.4 x 12.4
1.33 CU.FT.
9.0 LBS
TI X HI / 9 X 7

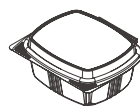

12oz TALL

RPTHLD12T
5.6 x 4.9 x 2.3
200 PCS / CASE
CASE DIMS. (in)
19.3 x 10.4 x 12.4
1.44 CU.FT.
9.6 LBS
TI X HI / 9 X 7

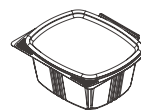

16oz

RPTHLD16
5.6 x 4.9 x 2.5
200 PCS / CASE
CASE DIMS. (in)
20.1 x 10.4 x 12.4
1.50 CU.FT.
10.3 LBS
TI X HI / 8 X 7

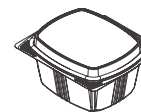

16oz TALL

RPTHLD16T
5.6 x 4.9 x 2.8
200 PCS / CASE
CASE DIMS. (in)
20.1 x 10.4 x 12.4
1.50 CU.FT.
11.1 LBS
TI X HI / 8 X 7

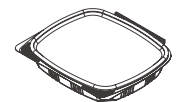

16oz SHALLOW

RPTHLD16S
7.2 x 6.4 x 1.3
200 PCS / CASE
CASE DIMS. (in)
16.7 x 13.8 x 15.4
2.05 CU.FT.
16.3 LBS
TI X HI / 7 X 6

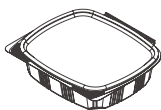

24oz

RPTHLD24
7.2 x 6.4 x 1.9
200 PCS / CASE
CASE DIMS. (in)
18.9 x 13.8 x 15.4
2.31 CU.FT.
17.6 LBS
TI X HI / 7 X 6

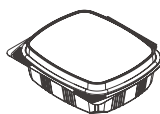

24oz TALL

RPTHLD24T
7.2 x 6.4 x 2.2
200 PCS / CASE
CASE DIMS. (in)
20.5 x 13.8 x 15.4
2.51 CU.FT.
19.2 LBS
TI X HI / 7 X 6



32oz

RPTHLD32
7.2 x 6.4 x 2.6
200 PCS / CASE
CASE DIMS. (in)
20.1 x 13.8 x 15.4
2.46 CU.FT.
18.9 LBS
TI X HI / 7 X 6

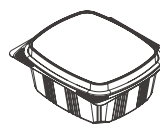

32oz TALL

RPTHLD32T
7.2 x 6.4 x 2.9
200 PCS / CASE
CASE DIMS. (in)
20.1 x 13.8 x 15.4
2.46 CU.FT.
18.4 LBS
TI X HI / 7 X 6

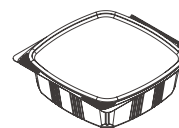

48oz

RPTHLD48
8.0 x 7.9 x 2.5
200 PCS / CASE
CASE DIMS. (in)
19.3 x 16.9 x 16.9
3.20 CU.FT.
25.1 LBS
TI X HI / 4 X 5

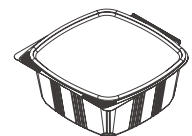

64oz

RPTHLD64
8.0 x 7.9 x 3.3
200 PCS / CASE
CASE DIMS. (in)
22.0 x 16.9 x 16.9
3.66 CU.FT.
28.6 LBS
TI X HI / 4 X 5

PET CLEAR SALAD BOWLS

Clear PET salad bowls (KODACUP®) deliver durable, crack-resistant performance with premium clarity—ideal for merchandising pre-packed salads and fresh-cut fruit.

The no-spill lid is perfect for stacking. Available in bulk or combo pack, and clear or black bases.



175 mm / 6.89" Dia.



18oz

PTSB18-D175
6.9 x 2.8
150 SETS / CASE
CASE DIMS. (in)
21.4 x 7.4 x 22.2
2.04 CU.FT.
9.1 LBS
TI X HI / 10 X 4



24oz

PTSB24-D175
6.9 x 3.2
150 SETS / CASE
CASE DIMS. (in)
21.4 x 7.4 x 23.0
2.10 CU.FT.
10.3 LBS
TI X HI / 10 X 4



27oz

PTSB27-D175AP
6.8 x 2.8
630 PCS / CASE
CASE DIMS. (in)
21.3 x 14.3 x 22.9
4.03 CU.FT.
22.3 LBS
TI X HI / 7 X 4

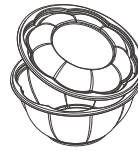

32oz

PTSB32-D175
6.9 x 4.0
150 SETS / CASE
CASE DIMS. (in)
21.4 x 7.4 x 23.6
2.16 CU.FT.
12.0 LBS
TI X HI / 10 X 4

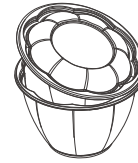

48oz

PTSB48-D175
6.9 x 5.2
150 SETS / CASE
CASE DIMS. (in)
21.4 x 7.4 x 24.4
2.23 CU.FT.
15.2 LBS
TI X HI / 10 X 4

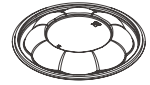

LID

PTSBLID-D175AP
6.9 x 0.8
630 PCS / CASE
CASE DIMS. (in)
21.3 x 14.3 x 15.6
2.72 CU.FT.
18.9 LBS
TI X HI / 7 X 5

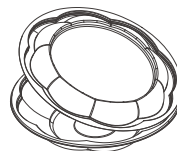

40oz

PTSB40-D255
10.0 x 3.0
100 SETS / CASE
CASE DIMS. (in)
20.5 x 10.9 x 15.4
1.98 CU.FT.
13.3 LBS
TI X HI / 6 X 6

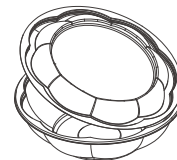

64oz

PTSB64-D255
10.0 x 3.9
100 SETS / CASE
CASE DIMS. (in)
20.5 x 10.9 x 17.5
2.25 CU.FT.
15.1 LBS
TI X HI / 6 X 5

255 mm / 10.04" Dia.

RPET 2-COMPARTMENT CONTAINER WITH 2 SINGLE-COMPARTMENT LIDS

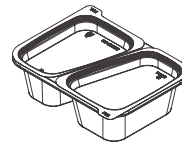

16oz
11.8oz x 2

RP16-2C-LIDC
7.0 x 5.2 x 2.1
228 SETS / CASE
CASE DIMS. (in)
14.6 x 11.5 x 23.7
2.32 CU.FT.
23.6 LBS
TI X HI / 10 X 3

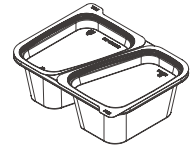

20oz
12.9oz x 2

RP20-2C-LIDC
7.0 x 5.2 x 2.6
228 SETS / CASE
CASE DIMS. (in)
14.6 x 11.5 x 23.7
2.32 CU.FT.
23.6 LBS
TI X HI / 10 X 3

Keeps foods fresh and separated, preventing flavor transfer and maintaining product integrity.

The lid allows for stable stacking to maximize shelf space.

PET FILM SEAL CONTAINERS



4x4"



8oz

PTFS448
4.4 x 4.4 x 1.6
960 PCS / CASE
CASE DIMS. (in)
22.8 x 13.9 x 22.4
4.10 CU.FT.
27.6 LBS
TI X HI / 6 X 4

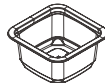

12oz

PTFS4412
4.4 x 4.4 x 2.2
720PCS / CASE
CASE DIMS. (in)
23.0 x 14.1 x 18.0
3.36 CU.FT.
23.5 LBS
TI X HI / 6 X 5



16oz

PTFS4416
4.4 x 4.4 x 2.9
720 PCS / CASE
CASE DIMS. (in)
22.8 x 13.9 x 18.7
3.41 CU.FT.
29.2 LBS
TI X HI / 6 X 4

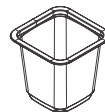

24oz

PTFS4424
4.4 x 4.4 x 4.1
585 PCS / CASE
CASE DIMS. (in)
22.8 x 13.9 x 17.1
3.12 CU.FT.
31.9 LBS
TI X HI / 6 X 5

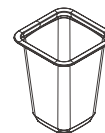

32oz

PTFS4432
4.4 x 4.4 x 5.6
1000 PCS / CASE
CASE DIMS. (in)
23.3 x 18.8 x 20.5
5.19 CU.FT.
61.3 LBS
TI X HI / 4 X 4



LID

PTFS44LID
4.7 x 4.7 x 0.6
1440 PCS / CASE
CASE DIMS. (in)
24.3 x 19.4 x 16.8
4.59 CU.FT.
23.8 LBS
TI X HI / 4 X 5

4x6"

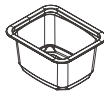

20oz
PTFS4620
5.4 x 4.4 x 2.9
540 PCS / CASE
CASE DIMS. (in)
16.7 x 13.9 x 22.4
3.01 CU.FT.
26.6 LBS
TI X HI / 7 X 4



LID
PTFS46LID
5.7 x 4.7 x 0.6
540PCS / CASE
CASE DIMS. (in)
17.6 x 14.7 x 15.1
2.26 CU.FT.
12.3 LBS
TI X HI / 6 X 6

5x6"

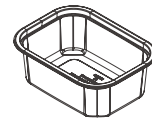

24oz
PTFS56-24
6.6 x 5.0 x 2.4
540 PCS / CASE
CASE DIMS. (in)
20.5 x 15.6 x 22.2
4.10 CU.FT.
28.4 LBS
TI X HI / 6 X 4

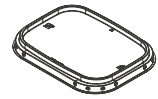

LID
PTFS56LID
6.9 x 5.3 x 0.5
540 PCS / CASE
CASE DIMS. (in)
21.4 x 16.5 x 12.7
2.59 CU.FT.
15.3 LBS
TI X HI / 5 X 7



8oz
PTFS08
5.2 x 4.6 x 1.3
1140 PCS / CASE
CASE DIMS. (in)
21.5 x 14.5 x 17.1
3.09 CU.FT.
22.8 LBS
TI X HI / 5 X 5

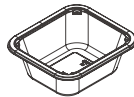

12oz
PTFS12
5.2 x 4.6 x 1.8
1140 PCS / CASE
CASE DIMS. (in)
21.5 x 14.5 x 17.6
3.18 CU.FT.
24.3 LBS
TI X HI / 5 X 5

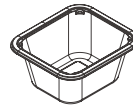

16oz
PTFS16
5.2 x 4.6 x 2.3
1140 PCS / CASE
CASE DIMS. (in)
21.5 x 14.5 x 17.8
3.21 CU.FT.
28.1 LBS
TI X HI / 5 X 5



8-16oz LID
PTFSSLID
5.5 x 4.9 x 0.5
1140 PCS / CASE
CASE DIMS. (in)
22.5 x 17.1 x 22.6
5.03 CU.FT.
24.3 LBS
TI X HI / 4 X 4

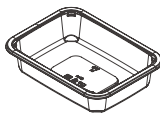

20oz
PTFS20
7.0 x 5.2 x 1.5
900 PCS / CASE
CASE DIMS. (in)
17.8 x 16.3 x 22.5
3.78 CU.FT.
31.4 LBS
TI X HI / 6 X 4

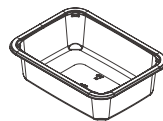

24oz
PTFS24
7.0 x 5.2 x 2.0
900 PCS / CASE
CASE DIMS. (in)
18.3 x 16.3 x 22.5
3.88 CU.FT.
35.3 LBS
TI X HI / 6 X 4

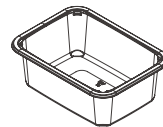

32oz
PTFS32
7.0 x 5.2 x 2.5
900 PCS / CASE
CASE DIMS. (in)
18.8 x 16.3 x 22.5
3.98 CU.FT.
35.9 LBS
TI X HI / 6 X 4



20-32oz LID
PTFSMLID
7.3 x 5.4 x 0.6
900 PCS / CASE
CASE DIMS. (in)
23.5 x 17.0 x 23.2
5.36 CU.FT.
29.0 LBS
TI X HI / 4 X 3

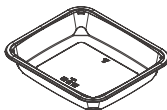

35oz
PTFS35
7.5 x 8.6 x 1.5
480 PCS / CASE
CASE DIMS. (in)
23.1 x 17.7 x 14.9
3.52 CU.FT.
32.1 LBS
TI X HI / 4 X 6

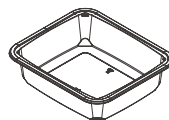

48oz
PTFS48
7.5 x 8.6 x 2.1
480 PCS / CASE
CASE DIMS. (in)
23.1 x 17.7 x 15.6
3.68 CU.FT.
33.2 LBS
TI X HI / 4 X 5

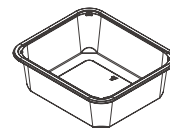

64oz
PTFS64
7.5 x 8.6 x 2.7
480 PCS / CASE
CASE DIMS. (in)
23.1 x 17.7 x 15.9
3.75 CU.FT.
41.2 LBS
TI X HI / 4 X 5

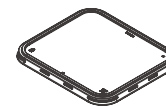

35-64oz LID
PTFSLID
8.8 x 7.7 x 0.6
480 PCS / CASE
CASE DIMS. (in)
19.5 x 16.1 x 27.4
4.96 CU.FT.
34.4 LBS
TI X HI / 6 X 3



LEAFY GREENS



4.5oz

PTFS50Z

8.9 x 7.0 x 3.4
564 PCS / CASE
CASE DIMS. (in)
22.0 x 18.6 x 22.8
5.40 CU.FT.
41.4 LBS
TIX HI / 4 X 4

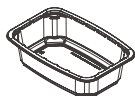

9.5oz

PTFS950Z

11.8 x 8.1 x 3.1
237 PCS / CASE
CASE DIMS. (in)
24.9 x 12.4 x 22.6
4.02 CU.FT.
29.9 LBS
TIX HI / 6 X 4

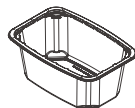

1LB

PTFS1LB

11.8 x 8.1 x 4.8
216 PCS / CASE
CASE DIMS. (in)
25.1 x 12.8 x 21.8
4.05 CU.FT.
32.9 LBS
TIX HI / 6 X 4

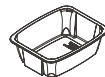

PTFSPGP5

9.0 x 7.2 x 2.8
352 PCS / CASE
CASE DIMS. (in)
18.7 x 15.2 x 27.5
4.53 CU.FT.
24.1LBS
TIX HI / 6 X 3

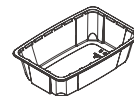

PTFSPGP9.5

12.3 x 8.1 x 3.2
261 PCS / CASE
CASE DIMS. (in)
25.0 x 12.9 x 27.2
5.07 CU.FT.
36.2 LBS
TIX HI / 6 X 3

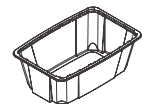

PTFSPGP16

12.3 x 8.1 x 4.3
249 PCS / CASE
CASE DIMS. (in)
25.0 x 12.9 x 27.2
5.08 CU.FT.
35.5 LBS
TIX HI / 6 X 3



PET BUTTER LETTUCE SINGLE & DOUBLE HINGED CONTAINERS

This container offers superb clarity and protection of the product.

Well suited for processors & green house packers.

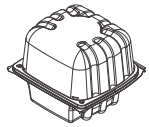

PTHBLC-1
7.3 x 6.6 x 5.7
270 PCS / CASE
CASE DIMS. (in)
23.8 x 15.7 x 13.9
3.01 CU.FT.
26.1 LBS
TI X HI / 5 X 6

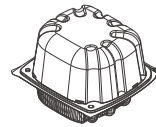

PTHBLC-1-TB
7.3 x 6.6 x 5.7
270 PCS / CASE
CASE DIMS. (in)
23.8 x 15.7 x 13.9
3.01 CU.FT.
24.9 LBS
TI X HI / 5 X 6

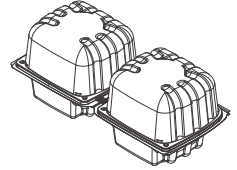

PTHBLC-2
15.0 x 6.5 x 5.7
135 PCS / CASE
CASE DIMS. (in)
23.8 x 15.7 x 13.9
3.01 CU.FT.
26.1 LBS
TI X HI / 5 X 6



PLATTERS

THE FIRST TAMPER-EVIDENT CATERING TRAYS IN THE INDUSTRY. AVAILABLE IN 10.7", 12", 14", AND 16" SIZES.



10.7"

Tamper Evident

PTTE107CT2-C
11.0 x 11.0 x 1.8
96 SETS / CASE
CASE DIMS. (in)
22.7 x 20.9 x 12.0
3.31 CU.FT.
25.3 LBS
TI X HI / 4 X 7



10.7"

Tamper Evident

PTTE107CT3-C
11.0 x 11.0 x 3.0
90 SETS / CASE
CASE DIMS. (in)
22.7 x 20.9 x 12.0
3.31 CU.FT.
25.8 LBS
TI X HI / 4 X 7

COMING SOON



12"

PTTE12CTB
12.2 x 12.2 x 3.5
86 SETS / CASE
CASE DIMS. (in)
24.9 x 18.2 x 13.2
3.46 CU.FT.
31.6 LBS
TI X HI / 4 X 6



14"

PTTE14CT-C
14.2 x 14.2 x 4.5
51 SETS / CASE
CASE DIMS. (in)
22.4 x 15.2 x 15.5
3.04 CU.FT.
25.6 LBS
TI X HI / 5 X 6



16"

PTTE16CT-C
16.1 x 16.1 x 4.5
35 SETS / CASE
CASE DIMS. (in)
18.5 x 16.7 x 17.5
3.14 CU.FT.
25.0 LBS
TI X HI / 6 X 5

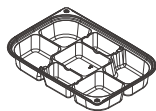

7 CELL TRAY

13.6oz, 13.2oz x 2, 11.7oz x 2, 6.1oz x 2

PTTE913-7C
13.8 x 10.6 x 2.1
100 PCS / CASE
CASE DIMS. (in)
20.4 x 14.4 x 17.9
3.04 CU.FT.
16.7 LBS
TI X HI / 5 X 5

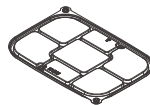

**7 CELL TRAY
VENTED LID**

PTTE913-7CLID-V
13.8 x 10.6 x 0.4
100 PCS / CASE
CASE DIMS. (in)
19.8 x 14.4 x 16.5
2.72 CU.FT.
16.1 LBS
TI X HI / 6 X 5



PET CAKE & BAKERY CONTAINERS



KODACUP branded Cake & Bakery Container with clear dome lids are a perfect fit for 6-10" cakes and pies.



Easy to label on the side of the cake dome.



6" PETITE

PTCC6
6.3 x 8.1 x 6.2
100 SETS / CASE
CASE DIMS. (in)
31.5 x 16.1 x 8.9
2.61 CU.FT.
18.8 LBS
TI X HI / 3 X 10

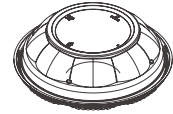

9" PIE

PTPC9SL
6.0 x 10.2 x 3.9
110 SETS / CASE
CASE DIMS. (in)
25.2 x 20.9 x 10.6
3.23 CU.FT.
20.3 LBS
TI X HI / 2 X 8

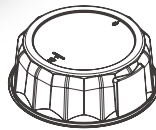

8" SINGLE

NFPTCC8SL
9.2 x 10.4 x 3.6
100 SETS / CASE
CASE DIMS. (in)
24.4 x 20.9 x 11.2
3.31 CU.FT.
23.2 LBS
TI X HI / 2 X 7

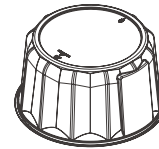

8" DOUBLE

NFPTCC8DL
8.9 x 10.4 x 5.5
100 SETS / CASE
CASE DIMS. (in)
24.4 x 20.9 x 11.2
3.31 CU.FT.
24.1 LBS
TI X HI / 2 X 7

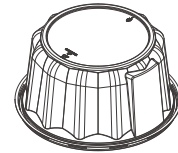

10" DOUBLE

PTCC10DL
7.7 x 11.2 x 5.5
50 SETS / CASE
CASE DIMS. (in)
22.0 x 17.5 x 12.0
2.68 CU.FT.
15.2 LBS
TI X HI / 4 X 7

PET STRAWBERRY LONG BAR CAKE CONTAINER

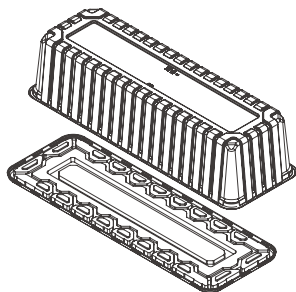

SBCL-B500
20.8 x 7.1 x 5.0
25 SETS / CASE
CASE DIMS. (in)
23.3 x 21.9 x 8.3
2.44 CU.FT.
13.1 LBS
TI X HI / 4 X 10

PET 3-COMPARTMENT COOKIES CONTAINER

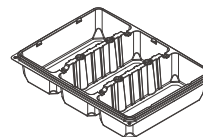

60oz
PT1082-3C
10.5 x 7.8 x 2.2
162 PCS / CASE
CASE DIMS. (in)
24.2 x 11.3 x 15.1
2.38 CU.FT.
19.2 LBS
TI X HI / 8 X 6

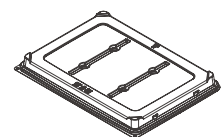

DOME LID
PT108DLID
10.5 x 7.8 x 0.9
162 PCS / CASE
CASE DIMS. (in)
24.2 x 11.3 x 13.8
2.18 CU.FT.
11.9 LBS
TI X HI / 8 X 8

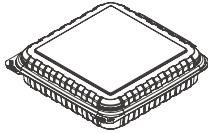

BHC70-225R
 9.4 x 8.9 x 2.2
 232 PCS / CASE
 CASE DIMS. (in)
 38.0 x 9.8 x 21.9
 4.69 CU.FT.
 28.8 LBS
 T I X H I / 5 X 4

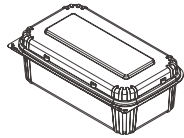

BHC35
 9.0 x 5.3 x 3.2
 100 PCS / CASE
 CASE DIMS. (in)
 18.5 x 11.3 x 14.8
 1.80 CU.FT.
 9.9 LBS
 T I X H I / 8 X 6

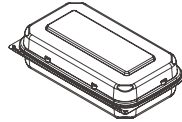

BHC35-225
 9.0 x 5.3 x 2.5
 280 PCS / CASE
 CASE DIMS. (in)
 22.8 x 18.9 x 18.2
 4.54 CU.FT.
 23.9 LBS
 T I X H I / 4 X 5



BHC35-275
 9.0 x 5.2 x 2.8
 320 PCS / CASE
 CASE DIMS. (in)
 22.1 x 18.5 x 17.7
 4.19 CU.FT.
 31.8 LBS
 T I X H I / 4 X 5



BHCDB95
 13.4 x 5.6 x 2.7
 65 PCS / CASE
 CASE DIMS. (in)
 14.2 x 14.0 x 17.9
 2.05 CU.FT.
 9.73 LBS
 T I X H I / 9 X 5

PET BAKERY HINGED CONTAINER

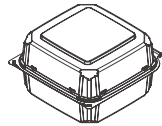

PTH66
 5.7 x 5.5 x 3.1
 356 SETS / CASE
 CASE DIMS. (in)
 22.9 x 13.4 x 12.3
 2.19 CU.FT.
 17.4 LBS
 T I X H I / 6 X 7

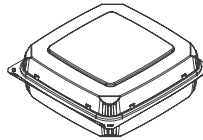

PTH88
 8.2 x 8.0 x 2.8
 300 SETS / CASE
 CASE DIMS. (in)
 23.7 x 16.9 x 16.9
 3.92 CU.FT.
 31.2 LBS
 T I X H I / 4 X 5

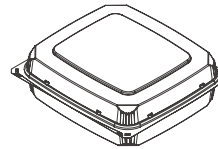

PTH98
 9.1 x 8.3 x 2.8
 164 SETS / CASE
 CASE DIMS. (in)
 18.8 x 13.4 x 17.6
 2.57 CU.FT.
 21.7 LBS
 T I X H I / 7 X 5

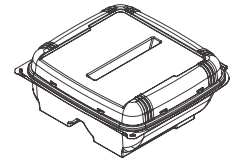

PTHSJC
 9.1 x 8.4 x 3.5
 100 SETS / CASE
 CASE DIMS. (in)
 22.8 x 17.2 x 10.1
 2.30 CU.FT.
 13.9 LBS
 T I X H I / 4 X 9

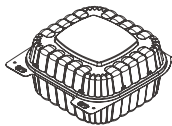

PTHDB66XL
 5.9 x 5.9 x 2.8
 320 PCS / CASE
 CASE DIMS. (in)
 25.0 x 13.4 x 13.0
 2.52 CU.FT.
 14.5 LBS
 T I X H I / 6 X 7

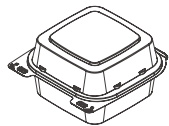

PTHDB66XLSW
 5.9 x 5.9 x 3.1
 400 PCS / CASE
 CASE DIMS. (in)
 24.8 x 19.6 x 12.8
 3.60 CU.FT.
 24.2 LBS
 T I X H I / 4 X 7



PET CLEAR ROUND DELI CONTAINERS

KODACUP branded PET clear Round Deli containers are perfect for high quality in store presentation.

Stackable containers offer maximum shelf space utilization.



8oz

PTRDC08
4.6 x 3.8 x 1.6
500 PCS / CASE
CASE DIMS. (in)
23.6 x 9.8 x 13.4
1.80 CU.FT.
11.4 LBS
TI X HI / 8 X 6



12oz

PTRDC12
4.6 x 3.7 x 2.4
500 PCS / CASE
CASE DIMS. (in)
23.6 x 9.8 x 13.6
1.83 CU.FT.
14.8 LBS
TI X HI / 8 X 6

HEAVY WEIGHT



12oz

PTRDC12H
4.6 x 3.7 x 2.4
500 PCS / CASE
CASE DIMS. (in)
23.6 x 9.8 x 13.6
1.83 CU.FT.
22.1 LBS
TI X HI / 8 X 6



16oz

PTRDC16
4.6 x 3.6 x 3.0
500 PCS / CASE
CASE DIMS. (in)
23.6 x 9.8 x 14.4
1.93 CU.FT.
19.3 LBS
TI X HI / 8 X 6

HEAVY WEIGHT



16oz

PTRDC16H
4.6 x 3.6 x 3.0
500 PCS / CASE
CASE DIMS. (in)
23.6 x 9.8 x 14.4
1.93 CU.FT.
22.1 LBS
TI X HI / 8 X 6



24oz

PTRDC24
4.6 x 3.4 x 4.3
500 PCS / CASE
CASE DIMS. (in)
23.6 x 9.8 x 16.1
2.17 CU.FT.
22.6 LBS
TI X HI / 8 X 5

HEAVY WEIGHT



24oz

PTRDC24H
4.6 x 3.4 x 4.3
500 PCS / CASE
CASE DIMS. (in)
23.6 x 9.8 x 16.1
2.17 CU.FT.
22.1 LBS
TI X HI / 8 X 5



32oz

PTRDC32
4.6 x 3.2 x 5.6
500 PCS / CASE
CASE DIMS. (in)
23.6 x 9.8 x 19.3
2.59 CU.FT.
25.2 LBS
TI X HI / 8 X 4



SNACK CUP

DR-SC-DL
4.6 x 2.7 x 4.8
250 SETS / CASE
CASE DIMS. (in)
22.4 x 15.0 x 10.2
1.98 CU.FT.
12.3 LBS
TI X HI / 5 X 9



DOME LID

PTRDCDOME
4.7 x 1.8
500 PCS / CASE
CASE DIMS. (in)
24.8 x 9.8 x 8.9
1.25 CU.FT.
10.4 LBS
TI X HI / 8 X 9



OVERCAP LID

PTRDCLIDOUT
4.7 x 0.5
500 PCS / CASE
CASE DIMS. (in)
24.8 x 9.8 x 9.4
1.33 CU.FT.
6.9 LBS
TI X HI / 8 X 9



RECESSED LID

PTRDCLIDIN
4.8 x 0.3
500 PCS / CASE
CASE DIMS. (in)
24.8 x 9.8 x 9.4
1.33 CU.FT.
7.1 LBS
TI X HI / 8 X 9

PET CLEAR CUPS & LIDS



92 mm / 3.62" Dia.



9oz FILM SEAL

PTC09FS-D92
3.6 x 2.2 x 2.9
1,000 PCS / CASE
CASE DIMS. (in)
18.7 x 15.2 x 15.2
2.50 CU.FT.
22.2 LBS
TI X HI / 6 X 5



9oz SMOOTH WALL

PTC09SW-D92
3.6 x 2.2 x 2.8
1,000 PCS / CASE
CASE DIMS. (in)
18.7 x 15.2 x 13.7
2.26 CU.FT.
22.2 LBS
TI X HI / 6 X 6



12oz TALL

PTC12-D92
3.6 x 2.4 x 4.2
1,000 PCS / CASE
CASE DIMS. (in)
18.7 x 15.2 x 17.1
2.82 CU.FT.
27.6 LBS
TI X HI / 6 X 5



16oz

PTC16-D92
3.6 x 2.4 x 4.9
1,000 PCS / CASE
CASE DIMS. (in)
18.7 x 15.2 x 21.5
3.53 CU.FT.
31.4 LBS
TI X HI / 6 X 4



20oz

PTC20-D92
3.6 x 2.6 x 5.8
1,000 PCS / CASE
CASE DIMS. (in)
18.7 x 15.2 x 16.9
2.79 CU.FT.
39.0 LBS
TI X HI / 6 X 5



4oz INSERT

PTINS-D92
3.6 x 2.6 x 1.0
1,000 PCS / CASE
CASE DIMS. (in)
19.3 x 8.4 x 10.0
0.94 CU.FT.
7.7 LBS
TI X HI / 10 X 9



4oz INSERT

PTINS-D92-DEEP
3.6 x 2.5 x 1.3
1,000 PCS / CASE
CASE DIMS. (in)
19.3 x 8.4 x 10.8
1.02 CU.FT.
7.7 LBS
TI X HI / 10 X 8



NO SLOT

PTLID-F92NS
3.6 x 0.4
1,000 PCS / CASE
CASE DIMS. (in)
19.1 x 15.6 x 8.3
1.42 CU.FT.
6.8 LBS
TI X HI / 6 X 10



STRAW SLOT

PTLID-F92SS
3.6 x 0.4
1,000 PCS / CASE
CASE DIMS. (in)
19.1 x 15.6 x 8.3
1.42 CU.FT.
6.8 LBS
TI X HI / 6 X 9



NO SLOT w/TAB

PTLID-F92NS-T
3.6 x 0.4
1,000 PCS / CASE
CASE DIMS. (in)
19.7 x 16.0 x 10.3
1.88 CU.FT.
8.3 LBS
TI X HI / 6 X 9



FILM SEAL

PTLID-92FS
3.9 x 0.5
1,000 PCS / CASE
CASE DIMS. (in)
20.2 x 16.3 x 10.8
20.6 CU.FT.
11.0 LBS
TI X HI / 5 X 8



NO HOLE

PTLID-D92NH
3.6 x 1.8
1,000 PCS / CASE
CASE DIMS. (in)
19.5 x 16.7 x 8.3
1.56 CU.FT.
9.5 LBS
TI X HI / 10 X 4



SQUARE NO HOLE

PTLID-D92SDNH
3.6 x 1.6
1,000 PCS / CASE
CASE DIMS. (in)
20.5 x 18.5 x 8.7
1.90 CU.FT.
11.8 LBS
TI X HI / 4 X 10



ROUND HOLE

PTLID-D92RH
3.6 x 1.8
1,000 PCS / CASE
CASE DIMS. (in)
19.5 x 16.7 x 8.3
1.56 CU.FT.
9.5 LBS
TI X HI / 4 X 11



WIDE HOLE

PTLID-D92WH
3.6 x 1.5
1,000 PCS / CASE
CASE DIMS. (in)
19.5 x 18.1 x 8.3
1.69 CU.FT.
9.9 LBS
TI X HI / 4 X 10

98 mm / 3.86" Dia.



12/14oz

PTC14-D98
3.9 x 2.2 x 4.0
1,000 PCS / CASE
CASE DIMS. (in)
19.9 x 15.9 x 14.8
2.70 CU.FT.
29.5 LBS
TI X HI / 6 X 6



16/18oz

PTC16-D98
3.9 x 2.5 x 4.7
1,000 PCS / CASE
CASE DIMS. (in)
19.9 x 15.9 x 15.0
2.74 CU.FT.
34.6 LBS
TI X HI / 6 X 5



20oz

PTC20-D98
3.9 x 2.3 x 5.4
1,000 PCS / CASE
CASE DIMS. (in)
19.9 x 15.9 x 16.5
3.02 CU.FT.
38.4 LBS
TI X HI / 6 X 5



24oz

PTC24-D98
3.9 x 2.4 x 5.9
600 PCS / CASE
CASE DIMS. (in)
15.7 x 11.8 x 18.9
2.03 CU.FT.
24.7 LBS
TI X HI / 10 X 4



4oz INSERT

PTINS-D98
3.9 x 3.0 x 1.3
1,000 PCS / CASE
CASE DIMS. (in)
20.1 x 8.5 x 12.8
1.26 CU.FT.
9.4 LBS
TI X HI / 9 X 7



NO SLOT

PTLID-F98NS
3.9 x 0.4
1,000 PCS / CASE
CASE DIMS. (in)
20.9 x 17.0 x 8.3
1.72 CU.FT.
8.9 LBS
TI X HI / 4 X 10



STRAW SLOT

PTLID-F98SS
3.9 x 0.4
1,000 PCS / CASE
CASE DIMS. (in)
20.9 x 17.0 x 8.3
1.72 CU.FT.
9.0 LBS
TI X HI / 4 X 10



STRAWLESS SIP LID

PTLID-S98
3.9 x 0.9
1,000 PCS / CASE
CASE DIMS. (in)
20.9 x 16.8 x 9.3
1.87 CU.FT.
9.6 LBS
TI X HI / 4 X 10



NO HOLE

PTLID-D98NH
3.9 x 1.8
1,000 PCS / CASE
CASE DIMS. (in)
20.7 x 17.5 x 8.9
1.86 CU.FT.
11.7 LBS
TI X HI / 4 X 10



ROUND HOLE

PTLID-D98RH
3.9 x 1.8
1,000 PCS / CASE
CASE DIMS. (in)
20.7 x 17.5 x 8.9
1.86 CU.FT.
11.7 LBS
TI X HI / 4 X 10



WIDE HOLE

PTLID-D98WH
3.9 x 1.6
1,000 PCS / CASE
CASE DIMS. (in)
20.7 x 17.5 x 8.9
1.86 CU.FT.
11.7 LBS
TI X HI / 4 X 10



78 mm / 3.07" Dia.



7oz

PTC07-D78
3.1 x 1.9 x 3.2
1,000 PCS / CASE
CASE DIMS. (in)
15.7 x 12.6 x 13.0
1.49 CU.FT.
17.5 LBS
TI X HI / 9 X 7



8oz

PTC08-D78
3.1 x 2.1 x 3.2
1,000 PCS / CASE
CASE DIMS. (in)
15.7 x 12.6 x 16.5
1.90 CU.FT.
16.2 LBS
TI X HI / 9 X 5



10oz

PTC10-D78
3.1 x 2.0 x 4.0
1,000 PCS / CASE
CASE DIMS. (in)
15.7 x 12.6 x 17.3
1.99 CU.FT.
17.8 LBS
TI X HI / 9 X 5



STRAW SLOT

PTLID-F78SS
3.1 x 0.3
2,000 PCS / CASE
CASE DIMS. (in)
16.3 x 13.6 x 13.4
1.72 CU.FT.
8.8 LBS
TI X HI / 9 X 7



ROUND HOLE

PTLID-D78RH
3.1 x 1.5
2,000 PCS / CASE
CASE DIMS. (in)
17.3 x 16.1 x 13.0
2.10 CU.FT.
11.9 LBS
TI X HI / 4 X 7



107 mm / 4.21" Dia.



32oz

PTC32-D107
4.2 x 2.9 x 6.9
500 PCS / CASE
CASE DIMS. (in)
22.2 x 17.9 x 16.9
3.90 CU.FT.
32.8 LBS
TI X HI / 4 X 5



STRAW SLOT

PTLID-F107SS
4.2 x 0.4
500 PCS / CASE
CASE DIMS. (in)
22.0 x 9.4 x 9.4
1.14 CU.FT.
4.8 LBS
TI X HI / 8 X 9



STRAW SLOT

PTLID-D107SS
4.2 x 1.7
500 PCS / CASE
CASE DIMS. (in)
23.2 x 9.4 x 11.8
1.50 CU.FT.
6.9 LBS
TI X HI / 8 X 7







ROUND HOLE

PTLID-D107RH
4.2 x 1.7
500 PCS / CASE
CASE DIMS. (in)
23.2 x 9.4 x 11.8
1.50 CU.FT.
6.9 LBS
TI X HI / 8 X 8

PLA BIOPLASTIC CLEAR CUPS & LIDS





STORE IN A COOL PLACE. IDEAL BEVERAGE TEMPERATURE: 14°F (-10°C) TO 104°F (40°C).

92 mm / 3.62" Dia.

			
9oz SQUAT	12oz TALL	ROUND HOLE	STRAW SLOT
PLAC09SW-D92	PLAC12-D92	PLALID-D92RH	PLALID-F92SS
3.6 x 2.4 x 2.8	3.6 x 2.3 x 4.2	3.6 x 1.8	3.6 x 0.4
1,000 PCS / CASE	1,000 PCS / CASE	1,000 PCS / CASE	1,000 PCS / CASE
CASE DIMS. (in)	CASE DIMS. (in)	CASE DIMS. (in)	CASE DIMS. (in)
18.7 x 15.2 x 13.8	18.7 x 15.2 x 14.8	19.5 x 18.1 x 8.3	19.1 x 15.6 x 8.3
2.27 CU.FT.	2.43 CU.FT.	1.69 CU.FT.	1.42 CU.FT.
22.2 LBS	25.0 LBS	9.1 LBS	6.8 LBS
TI X HI / 6 X 6	TI X HI / 6 X 6	TI X HI / 4 X 11	TI X HI / 6 X 9



96 mm / 3.78" Dia.

				
9oz	12/14oz	16/18oz	20oz	24oz
PLAC09SW-D96	PLAC12-D96	PLAC16-D96	PLAC20-D96	PLAC24-D96
3.8 x 2.2 x 3.1	3.8 x 2.1 x 4.2	3.8 x 2.4 x 4.9	3.8 x 2.4 x 5.5	3.8 x 2.5 x 6.0
1,000 PCS / CASE	1,000 PCS / CASE	1,000 PCS / CASE	1,000 PCS / CASE	1,000 PCS / CASE
CASE DIMS. (in)	CASE DIMS. (in)	CASE DIMS. (in)	CASE DIMS. (in)	CASE DIMS. (in)
19.8 x 15.9 x 13.8	19.8 x 15.9 x 15.2	19.8 x 15.9 x 21.7	19.8 x 15.9 x 24.0	19.8 x 15.9 x 25.6
2.52 CU.FT.	2.77 CU.FT.	3.95 CU.FT.	4.38 CU.FT.	4.67 CU.FT.
19.5 LBS	25.8 LBS	30.8 LBS	30.4 LBS	34.4 LBS
TI X HI / 6 X 6	TI X HI / 6 X 5	TI X HI / 6 X 4	TI X HI / 6 X 3	TI X HI / 6 X 3

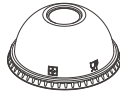

	
STRAW SLOT	ROUND HOLE
PLALID-F96SS	PLALID-D96RH
3.8 x 0.4	3.8 x 1.8
1,000 PCS / CASE	1,000 PCS / CASE
CASE DIMS. (in)	CASE DIMS. (in)
20.2 x 17.0 x 8.4	20.3 x 16.4 x 10.4
1.68 CU.FT.	2.01 CU.FT.
8.3 LBS	10.3 LBS
TI X HI / 4 X 11	TI X HI / 4 X 8

STORE IN A COOL PLACE. IDEAL BEVERAGE TEMPERATURE: 14°F (-10°C) TO 104°F (40°C).

98 mm / 3.86" Dia.



12/14oz

PLAC14-D98
3.9 x 2.2 x 4.0
1,000 PCS / CASE
CASE DIMS. (in)
19.9 x 15.9 x 14.8
2.70 CU.FT.
28.6 LBS
TI X HI / 6 X 6



16/18oz

PLAC16-D98
3.9 x 2.5 x 4.7
1,000 PCS / CASE
CASE DIMS. (in)
20.0 x 15.9 x 14.6
2.69 CU.FT.
30.6 LBS
TI X HI / 5 X 6



20oz

PLAC20-D98
3.9 x 2.4 x 5.4
1,000 PCS / CASE
CASE DIMS. (in)
19.9 x 15.9 x 16.5
3.02 CU.FT.
35.6 LBS
TI X HI / 5 X 5



24oz

PLAC24-D98
3.9 x 2.4 x 5.9
600 PCS / CASE
CASE DIMS. (in)
15.7 x 11.8 x 18.9
2.03 CU.FT.
22.3 LBS
TI X HI / 10 X 4



STRAW SLOT

PLALID-F98SS
3.9 x 0.4
1,000 PCS / CASE
CASE DIMS. (in)
20.9 x 17.0 x 9.1
1.88 CU.FT.
8.3 LBS
TI X HI / 4 X 9

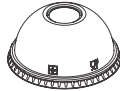

ROUND HOLE

PLALID-D98RH
3.9 x 1.8
1,000 PCS / CASE
CASE DIMS. (in)
20.7 x 19.3 x 9.1
2.09 CU.FT.
10.8 LBS
TI X HI / 4 X 9

107 mm / 4.21" Dia.



32oz

PLAC32-D107
4.2 x 3.0 x 6.9
500 PCS / CASE
CASE DIMS. (in)
22.2 x 17.9 x 16.9
3.90 CU.FT.
31.1 LBS
TI X HI / 4 X 5



STRAW SLOT

PLALID-F107SS
4.2 x 0.4
500 PCS / CASE
CASE DIMS. (in)
22.0 x 9.4 x 9.4
1.14 CU.FT.
5.1 LBS
TI X HI / 8 X 9





CUSTOM PRINTING

GET YOUR MESSAGE DIRECTLY INTO THE HANDS OF YOUR CUSTOMERS.

Custom printing is the perfect solution to build your brand image and grow market awareness. It allows you to cost effectively advertise your company's brand - products, style and values - and provides a point of distinction for your brand in an otherwise saturated market. It is a portable billboard for your business right in your customers hands. It's an advantage that what we like to call "Brand In Hand".

Customize all your foodservice disposables – plastic drink cups and plastic round deli containers.



EASILY & EFFECTIVELY
PROMOTE YOUR BUSINESS

WE UNDERSTAND PRINTING



PRINTING APPLICATION

We have world-class printing equipment. For plastic cups and containers, we have four 6-color Van Dam UV offset printing machines.

PRINTING SERVICE

We manage all design and print services in-house. We can recreate or modify your existing artwork or our designers can help you develop an entirely new brand concept. We can even create mock-ups so that you can see what the actual product will look like once artwork is finalized.

5 STEPS

SIMPLE & EASY!

WE'RE HERE TO HELP

WHATEVER YOUR PRINTING NEEDS

01

Choose the cup or container size(s) you need. We offer a wide range of sizes on PET drink cups, PLA drink cups, and PET round deli containers.

02

Choose up to 6-colors for your plastic cups / containers, and up to 4-colors for your customized PLA drink cups.

03

Send us your artwork as an AI (Adobe Illustrator), EPS (Encapsulated PostScript) or PDF file. If electronic artwork is not available, send a sample of your cup or container and we will recreate the artwork by hand.

04

Once you have perfected your design, we will produce a digital file of the artwork for you to review and approve. We can also create a mock-up, if needed, for a minimal charge.

05

The printing process begins once the digital artwork file and/or mock-up has been approved and purchase order has been received. Custom printed products will be produced and delivered within our stated normal lead times.

Our minimum order quantity for most custom prints is 50,000 pieces per sku.

ARTWORK REQUIREMENTS



FILE FORMAT ▶ .AI

- Shapes and fonts must be outlined.
- Font size must be at least 8 pt bold.
- Artwork elements must be in layers, not merged.
- All images embedded and must be at least 300 dpi or higher.
- Define all colors CMYK or PANTONE® Solid Coated / Uncoated Color Code.
- PANTONE® Solid Coated Colors can be used, but not all colors can be achieved.



If your artwork is designed by Photoshop or Corel Draw, please save it as a high resolution PDF, AI, or EPS file.



BEVERAGE & FOOD
PACKAGING SOLUTIONS
TO MEET YOUR NEEDS

WWW.EATERYESSENTIALS.COM

P (469) 482-9066 **F** (801) 742-5398

Physical: 2425 W Daniieldale Rd., Dallas, TX 75237

Mailing Address: PO Box 593 Desoto, TX 75123