

**BEVERAGE & FOOD  
PACKAGING SOLUTIONS  
TO MEET YOUR NEEDS**



# **2026 PRODUCT CATALOG**

[WWW.EATERYESSENTIALS.COM](http://WWW.EATERYESSENTIALS.COM)

# INNOVATIVE DISPOSABLE PACKAGING SOLUTION FOR EVERY OCCASION

## EATERY ESSENTIALS

is focused on providing high quality, competitively priced plastic foodservice disposables to customers in the following channels: QSR, Cash & Carry, Distribution, Food Processors, Hospitality, Airlines, Entertainment, Supermarket/Grocery and C-Stores.

2425 W Daniieldale Rd., Dallas, TX 75237

Square Feet: 399,971

Office Finish: 19,396



Eatery Essentials is a vertically integrated manufacturer specializing in extrusion and thermoforming of polymer-based drink cups, food containers, and tamper-evident packaging solutions. Combined facilities and warehousing in excess of 2MM sq. ft.

## CERTIFICATION & CAPABILITIES

Certifications make us  
Global Food Safety Initiative  
(GFSI) certified.

FSSC-22000 FSSC-22000 BRC SQF



**2** PROGRESSIVE IN-LINE (extrusion and thermoforming) lines comprising all the operational components to transform raw polymers into finished products.

**14** EXTRUDERS with monthly capacity of 400 tons each of PET.

**26** HIGH-SPEED THERMOFORMERS producing PET, PLA, and PP cups and containers, delivering total capacity exceeding 200 million units per month.

## FACILITIES

CUPS & CONTAINERS  
PET, RPET, PLA, & PP

# INDEX

PAGE NO.

## **TAMPER EVIDENT CONTAINER SERIES**

- 05 TAMPER EVIDENT HINGED LID CONTAINERS
- 07 TAMPER EVIDENT HINGED COMPARTMENT CONTAINERS
- 08 AUTO CLOSING MACHINE
- 09 TAMPER EVIDENT 7X6" HINGED LID CONTAINERS
- 10 GRAB AND GO - HOAGIES, SANDWICH, WRAPS, & SNACK CONTAINERS
- 11 TAMPER EVIDENT HINGED LID PARFAIT CUPS

## **TAMPER EVIDENT SQUARE AND ROUND BOWLS**

- 12 TAMPER EVIDENT SQUARE BOWLS
- 15 TAMPER EVIDENT HINGED LID ROUND BOWLS

## **SQUARE DELI & SQUARE 1, 2, 4 CELLS**

- 16 TAMPER EVIDENT 8.5X8" 2C BULK & SQUARE DELI CONTAINERS
- 17 TAMPER EVIDENT 6X6" SQUARE 1, 2, & 4 CELL SERIES

## **PET CONTAINERS**

- 18 RPET HINGED LID DELI CONTAINERS
- 19 PET CLEAR SALAD BOWLS
- 20 RPET 2-COMPARTMENT CONTAINER WITH 2 SINGLE-COMPARTMENT LIDS

## **FILM SEAL & BUTTER LETTUCE**

- 20 PET FILM SEAL CONTAINERS
- 22 LEAFY GREENS
- 23 PET BUTTER LETTUCE SINGLE & DOUBLE HINGED CONTAINERS

## **CATERING TRAYS AND PLATTERS**

- 24 PLATTERS
- 25 PET CAKE & BAKERY CONTAINERS
- 27 PET CLEAR ROUND DELI CONTAINERS

## **PET CLEAR CUP & LIDS**

## **PLA CLEAR CUP & LIDS**

## **CUSTOM PRINTING**



**TAMPER EVIDENT  
CONTAINER SERIES**

**BUT-N-LOC®**

 PATENTED BUTTON LOCK DESIGN

- ◆ Original innovators of the button-lock design
- ◆ Only tamper-evident solution compatible with both one-piece hinged and two-piece containers
- ◆ No sharp edges; eliminates wasteful tear strips
- ◆ Available in post-consumer recycled (PCR) PET
- ◆ High clarity with a secure, leak-resistant lid fit

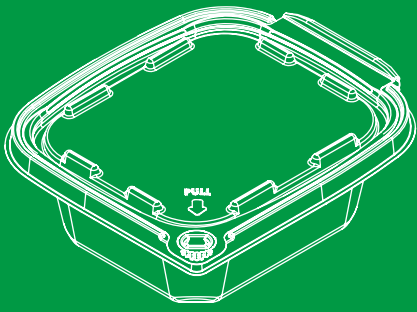

## HINGED LID TYPE

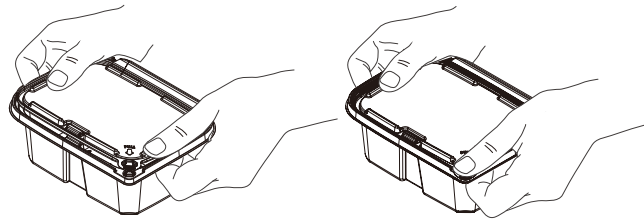

CLOSE THE LID

PUSH TO "LOC" BUTTON

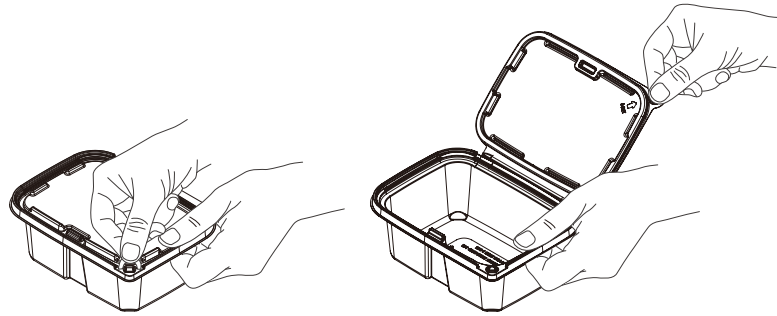

PULL THE TAB, BUTTON REMAINS

OPEN THE LID

 PATENTED BUTTON LOCK DESIGN

# BUT-N-LOC®

The innovative tamper-resistant locking mechanism and seal ensures quality and eliminates the need for shrink bands and wrap labels.

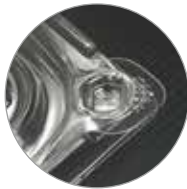

LOCKED



OPENED



NO LEAK LID

The button "Loc" tab fastens to the top of the base. If tampered with prior to purchase the **BUT-N-LOC®** button will not be connected to the tab and a clean hole in the tab will be evident. The engineered tight parameter seal promises a leak resistant experience.

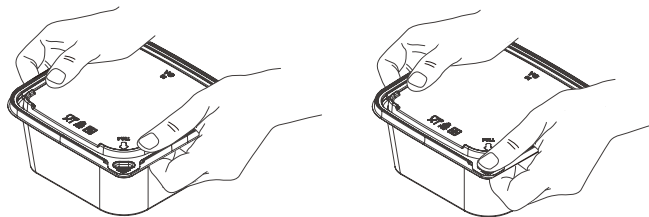

CLOSE THE LID

PUSH TO "LOC" BUTTON

## CLOSE & OPEN

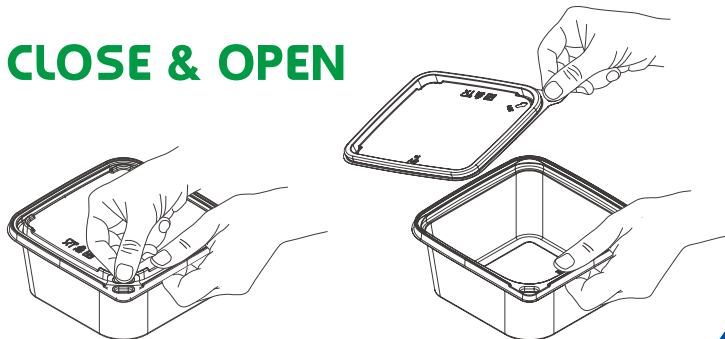

PULL THE TAB, BUTTON REMAINS

OPEN THE LID

## 2 PIECES TYPE

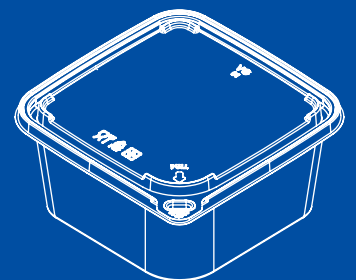

# TAMPER EVIDENT HINGED LID CONTAINER



**POST CONSUMER RECYCLED PET**

These containers available in PET, RPET, Blended RPET and PCR. \*Prices vary

Unlike other tamper evident containers that require a plastic tear-off strip, this container has no external pieces to throw away which makes for safer and smoother handling



**4oz**

RPTTE4AD  
4.3 x 3.5 x 1.3  
780 PCS / CASE  
CASE DIMS. (in)  
22.0 x 18.3 x 16.5  
3.85 CU.FT.  
19.1 LBS  
TI X HI / 4 X 5

VENTED



**4oz**

RPTTE4AD-V  
4.3 x 3.5 x 1.3  
780 PCS / CASE  
CASE DIMS. (in)  
22.0 x 18.3 x 16.5  
3.85 CU.FT.  
19.1 LBS  
TI X HI / 4 X 5



**6oz**

RPTTE6AD  
4.3 x 3.5 x 1.7  
780 PCS / CASE  
CASE DIMS. (in)  
22.2 x 18.3 x 17.0  
4.00 CU.FT.  
24.3 LBS  
TI X HI / 4 X 5

VENTED



**6oz**

RPTTE6AD-V  
4.3 x 3.5 x 1.7  
780 PCS / CASE  
CASE DIMS. (in)  
22.2 x 18.3 x 17.0  
4.00 CU.FT.  
24.3 LBS  
TI X HI / 4 X 5



**8oz**

RPTTE8  
5.8 x 5.0 x 1.5  
240 PCS / CASE  
CASE DIMS. (in)  
20.7 x 12.4 x 13.0  
1.93 CU.FT.  
10.9 LBS  
TI X HI / 8 X 7



**12oz**

RPTTE12  
5.8 x 5.0 x 2.0  
240 PCS / CASE  
CASE DIMS. (in)  
20.7 x 12.4 x 13.5  
2.00 CU.FT.  
11.7 LBS  
TI X HI / 8 X 6



**12oz SMOOTH WALL**

RPTTE12SW  
5.8 x 5.0 x 2.0  
280 PCS / CASE  
CASE DIMS. (in)  
24.0 x 16.3 x 10.3  
2.31 CU.FT.  
13.3 LBS  
TI X HI / 5 X 6



**16oz**

RPTTE16N  
5.8 x 5.0 x 2.6  
240 PCS / CASE  
CASE DIMS. (in)  
20.7 x 12.3 x 14.0  
2.08 CU.FT.  
13.9 LBS  
TI X HI / 8 X 6



**16oz SMOOTH WALL HEAVY**

RPTTE16SWH  
5.8 x 5.0 x 2.6  
280 PCS / CASE  
CASE DIMS. (in)  
23.6 x 15.4 x 11.0  
2.31 CU.FT.  
17.0 LBS  
TI X HI / 5 X 8



**16oz SMOOTH WALL HEAVY**

RPTTE16SWHV  
5.8 x 5.0 x 2.6  
280 PCS / CASE  
CASE DIMS. (in)  
23.6 x 15.4 x 11.0  
2.31 CU.FT.  
17.0 LBS  
TI X HI / 5 X 8



**16oz TEAR OFF LID**

RPTTE16TOL  
5.8 x 5.0 x 2.6  
240 PCS / CASE  
CASE DIMS. (in)  
23.6 x 15.4 x 11.0  
2.31 CU.FT.  
13.9 LBS  
TI X HI / 5 X 8

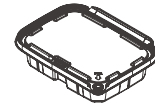

**20oz**

RPTTE20N  
7.4 x 5.7 x 1.8  
200 PCS / CASE  
CASE DIMS. (in)  
15.0 x 12.3 x 20.3  
2.17 CU.FT.  
16.2 LBS  
TI X HI / 11 X 4



**20oz SMOOTH WALL**

RPTTE20NSW-V  
7.4 x 5.6 x 1.8  
220 PCS / CASE  
CASE DIMS. (in)  
23.8 x 15.6 x 12.8  
2.74 CU.FT.  
17.6 LBS  
TI X HI / 5 X 7

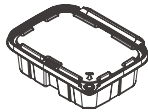

**24oz**

RPTTE24  
7.4 x 5.6 x 2.3  
200 PCS / CASE  
CASE DIMS. (in)  
15.0 x 12.3 x 20.8  
2.21 CU.FT.  
17.6 LBS  
TI X HI / 11 X 4

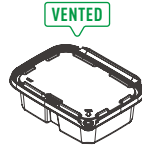

**24oz SMOOTH WALL**

RPTTE24SW-V  
7.4 x 5.6 x 2.3  
240 PCS / CASE  
CASE DIMS. (in)  
23.6 x 15.6 x 13.4  
2.84 CU.FT.  
20.7 LBS  
TI X HI / 5 X 7

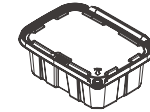

**32oz**

RPTTE32  
7.4 x 5.6 x 2.7  
200 PCS / CASE  
CASE DIMS. (in)  
15.0 x 12.3 x 21.3  
2.26 CU.FT.  
19.0 LBS  
TI X HI / 11 X 4

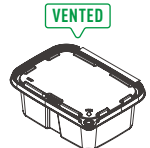

**32oz SMOOTH WALL**

RPTTE32SW-V  
7.4 x 5.7 x 2.7  
240 PCS / CASE  
CASE DIMS. (in)  
23.6 x 15.6 x 14.0  
2.97 CU.FT.  
22.3 LBS  
TI X HI / 5 X 6

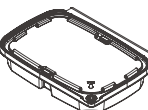

**24oz SMOOTH WALL**

RPTTE2P24SW  
8.3 x 6.0 x 1.7  
342 PCS / CASE  
CASE DIMS. (in)  
25.4 x 12.6 x 22.7  
4.19 CU.FT.  
31.6 LBS  
TI X HI / 6 X 4

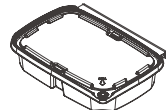

**28oz SMOOTH WALL**

RPTTE2P28SW  
8.3 x 6.0 x 1.9  
336 PCS / CASE  
CASE DIMS. (in)  
25.4 x 12.6 x 22.6  
4.18 CU.FT.  
33.3 LBS  
TI X HI / 6 X 4



**35oz SMOOTH WALL**

RPTTE35SW  
8.8 x 7.9 x 1.8  
180 PCS / CASE  
CASE DIMS. (in)  
18.3 x 16.8 x 18.1  
3.21 CU.FT.  
24.0 LBS  
TI X HI / 6 X 5

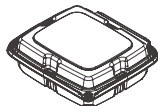

**35oz**

RPTTE35DL  
8.8 x 7.9 x 2.6  
180 PCS / CASE  
CASE DIMS. (in)  
17.5 x 17.1 x 18.2  
3.14 CU.FT.  
23.8 LBS  
TI X HI / 6 X 5

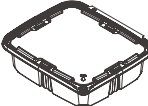

**48oz SMOOTH WALL**

RPTTE48SW  
8.8 x 7.9 x 2.4  
176 PCS / CASE  
CASE DIMS. (in)  
17.8 x 17.0 x 18.0  
3.15 CU.FT.  
25.1 LBS  
TI X HI / 6 X 5

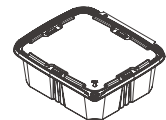

**64oz SMOOTH WALL**

RPTTE64SW  
8.8 x 7.9 x 3.0  
164 PCS / CASE  
CASE DIMS. (in)  
18.6 x 16.9 x 18.2  
3.31 CU.FT.  
27.5 LBS  
TI X HI / 6 X 5

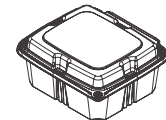

**64oz**

RPTTE64DL  
8.8 x 7.9 x 3.8  
164 PCS / CASE  
CASE DIMS. (in)  
18.6 x 16.9 x 18.2  
3.31 CU.FT.  
27.5 LBS  
TI X HI / 6 X 5



# TAMPER EVIDENT HINGED COMPARTMENT CONTAINERS



**16oz** 4 cell  
3.1oz x 4

RPTTE16SP4C  
7.4 x 5.6 x 1.5  
460 PCS / CASE  
CASE DIMS. (in)  
24.0 x 15.4 x 23.0  
4.92 CU.FT.  
38.5 LBS  
TI X HI / 5 X 4

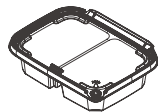

**20oz** 2 comp.  
9.3oz x 2

RPTTE20-2C  
7.4 x 5.7 x 1.8  
200 PCS / CASE  
CASE DIMS. (in)  
23.6 x 15.0 x 12.0  
2.46 CU.FT.  
17.7 LBS  
TI X HI / 5 X 7



**20oz** 3 comp.  
9.3oz, 4.1oz x 2

RPTTE20-3C  
7.4 x 5.7 x 1.8  
200 PCS / CASE  
CASE DIMS. (in)  
23.8 x 15.6 x 12.8  
2.74 CU.FT.  
17.7 LBS  
TI X HI / 5 X 7



**20oz** 4 comp.  
4.1oz x 4

RPTTE20-4C  
7.4 x 5.7 x 1.8  
200 PCS / CASE  
CASE DIMS. (in)  
23.8 x 15.6 x 12.8  
2.74 CU.FT.  
17.7 LBS  
TI X HI / 5 X 7

## TAMPER EVIDENT 6.5X6.5 RPET HINGED LID CONTAINER

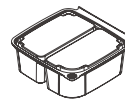

**2 CELL**  
16.7oz, 17.0oz

RPTTE6565-32-2C  
6.7 x 6.7 x 2.5  
195 PCS / CASE  
CASE DIMS. (in)  
24.4 x 13.7 x 21.5  
4.14 CU.FT.  
23.8 LBS  
TI X HI / 6 X 4

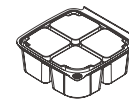

**4 CELL**  
7.5oz, 7.9oz x 3

RPTTE6565-32-4C  
6.7 x 6.7 x 2.5  
195 PCS / CASE  
CASE DIMS. (in)  
24.4 x 13.7 x 21.5  
4.14 CU.FT.  
23.8 LBS  
TI X HI / 6 X 4



DESIGNED FOR  
TAMPER EVIDENT  
HINGED LID CONTAINERS

# CLOSING MACHINE



IDEAL DESIGN FOR  
FRESH PRODUCE  
PACKAGING



ACCELERATES  
AND SIMPLIFIES  
CLOSING PROCESS



COMPACT, EASY TO USE,  
CLEAN AND MAINTAIN

## VPA200

SIZE (in) : 77.8 x 39.3 x 41.5  
WEIGHT (lb) : 330.7

CASE DIMS. (in) 85.8 x 47.2 x 54.7  
CASE. G.W.(lb) : 551.2

Automatic closing machine is designed specifically for our patented **BUT-N-LOC®** tamper evident hinged lid containers, operates with sizes 8oz to 64oz, and processes up to 80 containers per minute. Sturdy aluminum and steel construction with electronic control system for flexible ease of use operation.

Our machine increases productivity through reduced labor costs, improved reliability and output. Ideal secure packaging system for a wide variety of fresh food products, automatic closing machines are as efficient as they are effective.



# TAMPER EVIDENT 7X6" HINGED LID CONTAINERS



**16oz**

RPTTE76-16  
7.1 x 6.4 x 1.3  
348 PCS / CASE  
CASE DIMS. (in)  
21.9 x 13.4 x 22.7  
3.85 CU.FT.  
25.8 LBS  
TI X HI / 6 X 4



**24oz**

RPTTE76-24H  
7.1 x 6.4 x 1.9  
339 PCS / CASE  
CASE DIMS. (in)  
21.9 x 13.4 x 22.7  
3.85 CU.FT.  
30.2 LBS  
TI X HI / 6 X 4



**24oz**

RPTTE76-24HTV  
7.1 x 6.4 x 2.1  
339 PCS / CASE  
CASE DIMS. (in)  
21.9 x 13.4 x 22.7  
3.85 CU.FT.  
27.6 LBS  
TI X HI / 6 X 4



**32oz**

RPTTE76-32H  
7.1 x 6.4 x 2.6  
315 PCS / CASE  
CASE DIMS. (in)  
21.9 x 13.4 x 22.8  
3.88 CU.FT.  
31.7 LBS  
TI X HI / 6 X 4



**32oz**

RPTTE76-32HV  
7.1 x 6.4 x 2.6  
315 PCS / CASE  
CASE DIMS. (in)  
21.9 x 13.4 x 22.8  
3.87 CU.FT.  
31.7 LBS  
TI X HI / 6 X 4

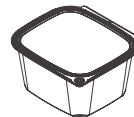

**48oz JUICE SEPARATOR**

RPTTE76-48JSV  
7.1 x 6.4 x 3.5  
196 PCS / CASE  
CASE DIMS. (in)  
14.8 x 13.4 x 23.4  
2.69 CU.FT.  
28.1 LBS  
TI X HI / 9 X 4

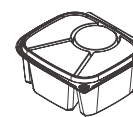

**TALL 4 comp.**  
5.7oz, 9.7oz x 3

RPTTE76-4CTV  
7.1 x 6.4 x 2.8  
264 PCS / CASE  
CASE DIMS. (in)  
21.9 x 13.4 x 23.4  
3.97 CU.FT.  
38.3 LBS  
TI X HI / 6 X 3

# GRAB & GO ITEMS!

## HOAGIE CONTAINER

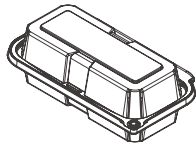

RPTTEHG  
9.1 x 4.9 x 2.9  
232 PCS / CASE  
CASE DIMS. (in)  
21.2 x 18.7 x 15.1  
3.47 CU.FT.  
20.9 LBS  
TI X HI / 4 X 6

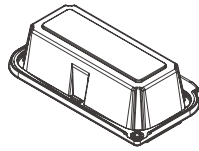

RPTTEHG-8R  
9.1 x 5.1 x 2.9  
222 PCS / CASE  
CASE DIMS. (in)  
21.3 x 9.7 x 21.8  
2.69 CU.FT.  
20.1 LBS  
TI X HI / 9 X 4



## SANDWICH WEDGE & WRAP

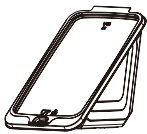

RPTTESW  
5.6 x 4.0 x 5.1  
250 PCS / CASE  
CASE DIMS. (in)  
20.7 x 15.6 x 14.2  
2.64 CU.FT.  
16.0 LBS  
TI X HI / 6 x 6



RPTTEWR  
6.1 x 6.0 x 2.0  
231 PCS / CASE  
CASE DIMS. (in)  
19.2 x 13.7 x 18.1  
2.75 CU.FT.  
20.3 LBS  
TI X HI / 6 x 5



LARGE SANDWICH  
RPTTEHSL  
5.7 x 4.6 x 3.6  
400 PCS / CASE  
CASE DIMS. (in)  
19.1 x 14.3 x 22.6  
3.57 CU.FT.  
31.3 LBS  
TI X HI / 6 x 4



SMALL SANDWICH  
RPTTEHSS  
5.3 x 4.5 x 2.3  
455 PCS / CASE  
CASE DIMS. (in)  
22.9 x 13.1 x 23.1  
4.02 CU.FT.  
27.3 LBS  
TI X HI / 6 x 4

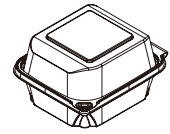

RPTTESWR3S  
6.0 x 5.1 x 3.5  
522 PCS / CASE  
CASE DIMS. (in)  
24.8 x 15.9 x 18.1  
4.15 CU.FT.  
28.7 LBS  
TI X HI / 4 x 5

## SMALL WRAP & SNACK CONTAINERS

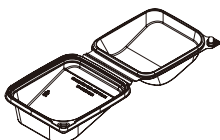

RPTTESWR  
5.6 x 5.1 x 2.2  
522 PCS / CASE  
CASE DIMS. (in)  
24.8 x 15.9 x 18.7  
4.28 CU.FT.  
40.2 LBS  
TI X HI / 5 x 5

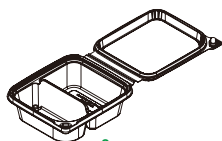

2 comp.  
4.8oz, 7.5oz  
RPTTESWR-2C  
6.1 x 5.1 x 2.0  
330 PCS / CASE  
CASE DIMS. (in)  
15.9 x 12.7 x 22.1  
2.59 CU.FT.  
22.6 LBS  
TI X HI / 9 x 4

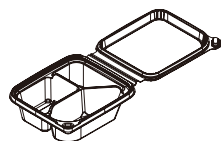

3 comp.  
3.4oz, 3.9oz x 2  
RPTTESWR-3C  
6.1 x 5.1 x 2.0  
330 PCS / CASE  
CASE DIMS. (in)  
15.9 x 12.7 x 22.3  
2.61 CU.FT.  
22.6 LBS  
TI X HI / 9 x 4

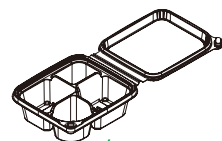

4 comp.  
2.4oz, 3.4oz, 3.5oz, 2.0oz  
RPTTESWR-4C  
6.1 x 5.1 x 2.0  
330 PCS / CASE  
CASE DIMS. (in)  
15.9 x 12.7 x 22.1  
2.59 CU.FT.  
22.6 LBS  
TI X HI / 9 x 4

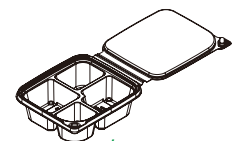

4 comp.  
2.4oz, 3.4oz, 3.5oz, 2.0oz  
RPTTESWR-R4C  
6.0 x 5.1 x 1.7  
330 PCS / CASE  
CASE DIMS. (in)  
15.9 x 12.7 x 22.0  
2.58 CU.FT.  
22.6 LBS  
TI X HI / 9 x 4



# TAMPER EVIDENT HINGED LID PARFAIT CUPS

These cups are suitable for cut fruit, cut veggies, brownie bites, cookies, yogurt parfaits, and other snacks.

Tight lid fit prevents spills - in the store and on the go - and helps maintain product freshness.

2 types insert options fits all cups. The new flat panel design makes it easy to apply a scale label and have it lay flat.



**9oz**

RPTTEFPC-09  
4.4 x 3.9 x 2.8  
500 PCS / CASE  
CASE DIMS. (in)  
22.8 x 16.7 x 15.2  
3.35 CU.FT.  
24.7 LBS  
TI X HI / 5 x 5



**11oz**

RPTTEFPC-11  
4.4 x 3.9 x 3.5  
500 PCS / CASE  
CASE DIMS. (in)  
22.8 x 16.7 x 16.1  
3.57 CU.FT.  
28.4 LBS  
TI X HI / 5 x 5



**13oz**

RPTTEFPC-13  
4.4 x 3.9 x 4.2  
450 PCS / CASE  
CASE DIMS. (in)  
22.8 x 16.7 x 15.7  
3.48 CU.FT.  
21.6 LBS  
TI X HI / 5 x 5

VENTED



**9oz**

RPTTEFPC-09V  
4.4 x 3.9 x 2.8  
500 PCS / CASE  
CASE DIMS. (in)  
22.8 x 16.7 x 15.2  
3.35 CU.FT.  
24.7 LBS  
TI X HI / 5 x 5

VENTED



**11oz**

RPTTEFPC-11V  
4.4 x 3.9 x 3.5  
500 PCS / CASE  
CASE DIMS. (in)  
22.8 x 16.7 x 16.1  
3.57 CU.FT.  
28.4 LBS  
TI X HI / 5 x 5

VENTED



**13oz**

RPTTEFPC-13V  
4.4 x 3.9 x 4.2  
450 PCS / CASE  
CASE DIMS. (in)  
22.8 x 16.7 x 15.7  
3.48 CU.FT.  
21.6 LBS  
TI X HI / 5 x 5



**3oz INSERT**

RPTTEFPC-INS  
3.7 x 3.2 x 1.2  
1200 PCS / CASE  
CASE DIMS. (in)  
19.7 x 15.4 x 12.0  
2.10 CU.FT.  
12.8 LBS  
TI X HI / 6 x 7



**4oz INSERT**

RPTTEFPC-IN  
3.7 x 3.2 x 1.4  
1200 PCS / CASE  
CASE DIMS. (in)  
19.7 x 15.4 x 12.4  
2.18 CU.FT.  
14.0 LBS  
TI X HI / 6 x 7



**4oz INSERT 2C**

RPTTEFPC-IN2  
3.7 x 3.2 x 1.4  
1200 PCS / CASE  
CASE DIMS. (in)  
19.7 x 15.4 x 12.4  
2.18 CU.FT.  
16.7 LBS  
TI X HI / 6 x 7



# TAMPER EVIDENT SQUARE BOWLS

**BUT-N-LOC**® branded PET Tamper Evident Square Bowls are ideal for processors, supermarkets, wholesale clubs, and C-stores. Crystal clear lids, crack resistant and leak resistant bowls to ensure safe and stable handling. Black or color bases also available.

**5.0"**  
127mm Dia.

Available in four footprints, 5", 6.5", 7.5", and 9". Each footprint available in a variety of capacities and compartments. The stackability of these square bowls may improve your shelf space utilization.



### 8oz

PTTESB5-08B  
5.0 x 5.0 x 1.6  
600 PCS / CASE  
CASE DIMS. (in)  
20.7 x 15.6 x 15.6  
2.89 CU.FT.  
16.1 LBS  
TIX HI / 5 X 5



### 12oz

PTTESB5-12B  
5.0 x 5.0 x 2.2  
600 PCS / CASE  
CASE DIMS. (in)  
20.7 x 15.6 x 15.7  
2.93 CU.FT.  
17.4 LBS  
TIX HI / 5 X 5



### 16oz

PTTESB5-16B  
5.0 x 5.0 x 2.9  
600 PCS / CASE  
CASE DIMS. (in)  
20.7 x 15.6 x 16.9  
3.15 CU.FT.  
20.1 LBS  
TIX HI / 5 X 5



### FLAT LID

PTTESBFLID5B  
5.0 x 5.0 x 0.3  
600 PCS / CASE  
CASE DIMS. (in)  
19.5 x 14.8 x 13.8  
2.29 CU.FT.  
15.2 LBS  
TIX HI / 6 X 6



### DOME LID

PTTESBDLID5B  
5.0 x 5.0 x 0.8  
600 PCS / CASE  
CASE DIMS. (in)  
19.5 x 14.8 x 13.4  
2.23 CU.FT.  
15.1 LBS  
TIX HI / 5 X 6

**6.5"**  
165mm Dia.



**18oz**

PTTESB65-18B  
6.5 x 6.5 x 1.9  
720 PCS / CASE  
CASE DIMS. (in)  
33.1 x 13.6 x 21.7  
5.63 CU.FT.  
26.0 LBS  
TI X HI / 4 X 4



**24oz**

PTTESB65-24B  
6.5 x 6.5 x 2.5  
720 PCS / CASE  
CASE DIMS. (in)  
33.1 x 13.6 x 22.2  
5.77 CU.FT.  
28.4 LBS  
TI X HI / 4 X 4



**32oz**

PTTESB65-32B  
6.5 x 6.5 x 3.4  
720 PCS / CASE  
CASE DIMS. (in)  
33.1 x 13.6 x 23.1  
6.02 CU.FT.  
30.8 LBS  
TI X HI / 4 X 4



**48oz**

PTTESB65-48B  
6.5 x 6.5 x 4.6  
720 PCS / CASE  
CASE DIMS. (in)  
33.1 x 13.6 x 24.3  
6.31 CU.FT.  
45.9 LBS  
TI X HI / 4 X 4

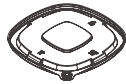

**FLAT LID**

PTTESBFLID65B  
6.1 x 6.1 x 0.5  
360 PCS / CASE  
CASE DIMS. (in)  
18.9 x 18.9 x 11.7  
2.42 CU.FT.  
14.7 LBS  
TI X HI / 4 X 7

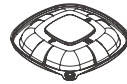

**DOME LID**

PTTESBDLID65B  
6.1 x 6.1 x 1.0  
360 PCS / CASE  
CASE DIMS. (in)  
18.9 x 18.9 x 12.2  
2.53 CU.FT.  
14.7 LBS  
TI X HI / 4 X 7

**7.5"**  
191mm Dia.



**18oz**

PTTESB75-18B  
7.5 x 7.5 x 1.6  
300 PCS / CASE  
CASE DIMS. (in)  
23.6 x 15.9 x 14.2  
3.09 CU.FT.  
15.4 LBS  
TI X HI / 5 X 6

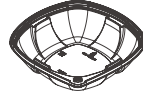

**24oz**

PTTESB75-24B  
7.5 x 7.5 x 1.9  
300 PCS / CASE  
CASE DIMS. (in)  
23.6 x 15.9 x 15.4  
3.35 CU.FT.  
16.8 LBS  
TI X HI / 5 X 6



**24oz 4 COMP.**

PTTESB75-24B-4C  
7.5 x 7.5 x 1.9  
300 PCS / CASE  
CASE DIMS. (in)  
23.6 x 15.9 x 15.4  
3.35 CU.FT.  
17.0 LBS  
TI X HI / 5 X 6



**32oz**

PTTESB75-32B  
7.5 x 7.5 x 2.4  
300 PCS / CASE  
CASE DIMS. (in)  
23.6 x 15.9 x 15.7  
3.43 CU.FT.  
17.4 LBS  
TI X HI / 5 X 6



**48oz**

PTTESB75-48B  
7.5 x 7.5 x 3.4  
300 PCS / CASE  
CASE DIMS. (in)  
23.6 x 15.9 x 17.1  
3.73 CU.FT.  
19.8 LBS  
TI X HI / 5 X 6

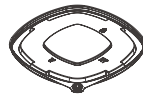

**FLAT LID**

PTTESBFLID75B  
7.1 x 7.1 x 0.4  
300 PCS / CASE  
CASE DIMS. (in)  
22.2 x 15.2 x 14.0  
2.73 CU.FT.  
14.0 LBS  
TI X HI / 5 X 6

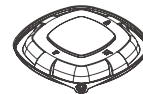

**DOME LID**

PTTESBDLID75B  
7.1 x 7.1 x 1.0  
300 PCS / CASE  
CASE DIMS. (in)  
22.2 x 15.2 x 13.8  
2.69 CU.FT.  
14.0 LBS  
TI X HI / 5 X 6

**9.0"**  
229mm Dia.

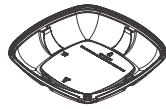

**30oz**

PTTESB9-30B-N  
9.0 x 9.0 x 1.6  
180 PCS / CASE  
CASE DIMS. (in)  
23.6 x 9.6 x 18.0  
2.37 CU.FT.  
13.9 LBS  
TI X HI / 8 X 5

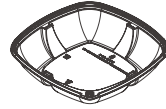

**40oz**

PTTESB9-40B-N  
9.0 x 9.0 x 2.0  
180 PCS / CASE  
CASE DIMS. (in)  
24.2 x 9.7 x 18.4  
2.49 CU.FT.  
14.3 LBS  
TI X HI / 8 X 5

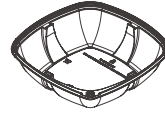

**48oz**

PTTESB9-48B-N  
9.0 x 9.0 x 2.4  
180 PCS / CASE  
CASE DIMS. (in)  
18.9 x 9.8 x 22.2  
2.39 CU.FT.  
14.9 LBS  
TI X HI / 10 X 4



**48oz 4 COMP.**

PTTESB9-48B-4C  
9.0 x 9.0 x 2.4  
180 PCS / CASE  
CASE DIMS. (in)  
18.9 x 9.8 x 22.2  
2.39 CU.FT.  
14.5 LBS  
TI X HI / 10 X 4

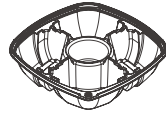

**48oz 5 COMP.**

PTTESB9-48B-5C  
9.0 x 9.0 x 2.4  
180 PCS / CASE  
CASE DIMS. (in)  
18.9 x 9.8 x 22.2  
2.38 CU.FT.  
15.7 LBS  
TI X HI / 10 X 4

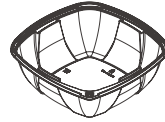

**64oz**

PTTESB9-64B-N  
9.0 x 9.0 x 3.1  
180 PCS / CASE  
CASE DIMS. (in)  
18.5 x 9.6 x 21.9  
2.24 CU.FT.  
17.3 LBS  
TI X HI / 10 X 4

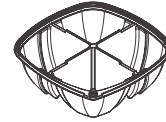

**64oz 4 COMP.**

PTTESB9-64B-4C-N  
9.0 x 9.0 x 3.1  
180 PCS / CASE  
CASE DIMS. (in)  
18.3 x 9.6 x 24.0  
2.43 CU.FT.  
17.4 LBS  
TI X HI / 10 X 4

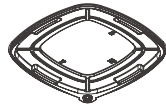

**FLAT LID**

PTTESBFLID9B  
8.6 x 8.6 x 0.5  
180 PCS / CASE  
CASE DIMS. (in)  
18.9 x 9.8 x 18.7  
2.01 CU.FT.  
13.1 LBS  
TI X HI / 10 X 5

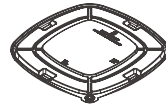

**FLAT LID**

PTTESBFLID9B-N  
8.6 x 8.6 x 0.5  
180 PCS / CASE  
CASE DIMS. (in)  
18.3 x 9.7 x 21.7  
2.22 CU.FT.  
13.1 LBS  
TI X HI / 10 X 4

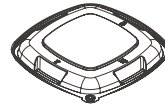

**DOME LID**

PTTESBDLID9B  
8.6 x 8.6 x 1.0  
180 PCS / CASE  
CASE DIMS. (in)  
18.9 x 9.8 x 17.9  
1.93 CU.FT.  
13.0 LBS  
TI X HI / 10 X 5

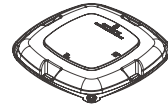

**DOME LID**

PTTESBDLID9B-N  
8.6 x 8.6 x 1.0  
180 PCS / CASE  
CASE DIMS. (in)  
18.3 x 9.6 x 23.6  
2.41 CU.FT.  
13.6 LBS  
TI X HI / 8 X 5

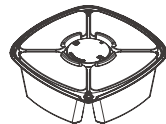

**5 COMP. JUICE SEPARATOR**

PTTESB9-LG5C2  
9.0 x 9.0 x 3.1  
180 SETS / CASE  
CASE DIMS. (in)  
18.3 x 9.7 x 22.2  
2.28 CU.FT.  
22.4 LBS  
TI X HI / 10 X 4

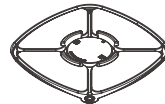

**FLAT LID**

PTTESBFLID2-9B  
8.6 x 8.6 x 0.5  
180 PCS / CASE  
CASE DIMS. (in)  
18.3 x 9.6 x 19.9  
2.03 CU.FT.  
14.1 LBS  
TI X HI / 10 X 4

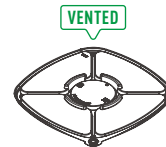

**FLAT LID**

PTTESBFLID2-9BV  
8.6 x 8.6 x 0.5  
180 PCS / CASE  
CASE DIMS. (in)  
17.9 x 9.3 x 19.9  
1.91 CU.FT.  
14.1 LBS  
TI X HI / 10 X 4



# TAMPER EVIDENT HINGED LID ROUND BOWLS

**POST CONSUMER RECYCLED PET**



**18oz**

RPTTERBM18  
7.2 x 7.0 x 2.4  
375 PCS / CASE  
CASE DIMS. (in)  
24.7 x 14.7 x 22.0  
4.62 CU.FT.  
32.0 LBS  
TI X HI / 5 X 4



**18oz**

RPTTERBM18-V  
7.2 x 7.0 x 2.4  
375 PCS / CASE  
CASE DIMS. (in)  
24.7 x 14.7 x 22.0  
4.62 CU.FT.  
32.0 LBS  
TI X HI / 5 X 4



**24oz**

RPTTERBM24  
7.2 x 7.0 x 3.0  
363 PCS / CASE  
CASE DIMS. (in)  
24.7 x 14.7 x 22.0  
4.62 CU.FT.  
32.6 LBS  
TI X HI / 5 X 4



**24oz**

RPTTERBM24-V  
7.2 x 7.0 x 3.0  
363 PCS / CASE  
CASE DIMS. (in)  
24.7 x 14.7 x 22.0  
4.62 CU.FT.  
32.6 LBS  
TI X HI / 5 X 4

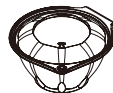

**32oz**

RPTTERBM32  
7.2 x 7.0 x 3.8  
351 PCS / CASE  
CASE DIMS. (in)  
24.7 x 14.7 x 22.0  
4.62 CU.FT.  
32.8 LBS  
TI X HI / 5 X 4



**32oz**

RPTTERBM32-V  
7.2 x 7.0 x 3.8  
351 PCS / CASE  
CASE DIMS. (in)  
24.7 x 14.7 x 22.0  
4.62 CU.FT.  
32.8 LBS  
TI X HI / 5 X 4



**40oz**

RPTTERBL40  
9.6 x 9.7 x 2.6  
126 PCS / CASE  
CASE DIMS. (in)  
19.4 x 16.6 x 19.6  
3.65 CU.FT.  
21.1 LBS  
TI X HI / 6 X 4



**40oz**

RPTTERBL40-V  
9.6 x 9.7 x 2.6  
126 PCS / CASE  
CASE DIMS. (in)  
19.4 x 16.6 x 19.6  
3.65 CU.FT.  
21.1 LBS  
TI X HI / 6 X 4



**48oz**

RPTTERBL48  
9.6 x 9.7 x 2.9  
120 PCS / CASE  
CASE DIMS. (in)  
19.4 x 16.6 x 19.6  
3.65 CU.FT.  
21.9 LBS  
TI X HI / 6 X 4



**48oz**

RPTTERBL48-V  
9.6 x 9.7 x 2.9  
120 PCS / CASE  
CASE DIMS. (in)  
19.4 x 16.6 x 19.6  
3.65 CU.FT.  
21.9 LBS  
TI X HI / 6 X 4



**64oz**

RPTTERBL64  
9.6 x 9.7 x 3.5  
108 PCS / CASE  
CASE DIMS. (in)  
19.4 x 16.6 x 19.6  
3.65 CU.FT.  
21.7 LBS  
TI X HI / 6 X 4



**64oz**

RPTTERBL64-V  
9.6 x 9.7 x 3.5  
108 PCS / CASE  
CASE DIMS. (in)  
19.4 x 16.6 x 19.6  
3.65 CU.FT.  
21.7 LBS  
TI X HI / 6 X 4



**80oz**

RPTTERBL80  
9.6 x 9.7 x 4.0  
102 PCS / CASE  
CASE DIMS. (in)  
19.4 x 16.6 x 19.6  
3.65 CU.FT.  
21.1 LBS  
TI X HI / 6 X 4



**80oz**

RPTTERBL80-V  
9.6 x 9.7 x 4.0  
102 PCS / CASE  
CASE DIMS. (in)  
19.4 x 16.6 x 19.6  
3.65 CU.FT.  
21.1 LBS  
TI X HI / 6 X 4

# TAMPER EVIDENT 8.5X8" 2C BULK

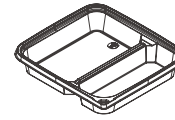

**28oz**  
PTTE858-2C  
8.5 x 7.9 x 1.6  
136 PCS / CASE  
CASE DIMS. (in)  
34.9 x 8.7 x 18.1  
3.19 CU.FT.  
10.2 LBS  
TI X HI / 5 X 5



**DOMELID**  
PTTE858-2CLID  
8.1 x 7.5 x 0.5  
136 PCS / CASE  
CASE DIMS. (in)  
33.8 x 8.5 x 15.9  
2.64 CU.FT.  
9.3 LBS  
TI X HI / 5 X 5



# TAMPER EVIDENT SQUARE DELI CONTAINERS

BUT-N-LOC® branded PET Tamper Evident Square Deli Containers are available in five sizes: 8, 12, 16, 24, and 32oz with one common lid fit for all sizes.

The lid allows for stable stacking to maximize shelf space.

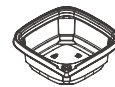

**8oz**  
PTTESDC08  
4.8 x 4.8 x 1.8  
500 PCS / CASE  
CASE DIMS. (in)  
24.6 x 10.4 x 13.0  
1.93 CU.FT.  
15.5 LBS  
TI X HI / 6 X 7

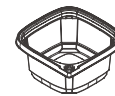

**12oz**  
PTTESDC12  
4.8 x 4.8 x 2.3  
500 PCS / CASE  
CASE DIMS. (in)  
24.6 x 10.4 x 14.2  
2.10 CU.FT.  
20.1 LBS  
TI X HI / 6 X 6



**16oz**  
PTTESDC16  
4.8 x 4.8 x 3.1  
500 PCS / CASE  
CASE DIMS. (in)  
24.6 x 10.4 x 15.0  
2.22 CU.FT.  
23.9 LBS  
TI X HI / 6 X 6



**24oz**  
PTTESDC24  
4.8 x 4.8 x 4.0  
500 PCS / CASE  
CASE DIMS. (in)  
24.6 x 10.4 x 16.9  
2.51 CU.FT.  
28.4 LBS  
TI X HI / 6 X 5



**32oz**  
PTTESDC32  
4.8 x 4.8 x 5.2  
500 PCS / CASE  
CASE DIMS. (in)  
24.6 x 10.4 x 19.7  
2.92 CU.FT.  
37.4 LBS  
TI X HI / 6 X 4



**LID**  
PTTESDCLID  
4.6 x 4.6 x 0.3  
500 PCS / CASE  
CASE DIMS. (in)  
22.8 x 9.8 x 11.4  
1.48 CU.FT.  
11.1 LBS  
TI X HI / 8 X 8



**LID**  
PTTESDCLID-V  
4.6 x 4.6 x 0.3  
500 PCS / CASE  
CASE DIMS. (in)  
22.8 x 9.8 x 11.4  
1.48 CU.FT.  
11.1 LBS  
TI X HI / 8 X 8

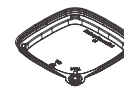

**RECESSED LID**  
PTTESDCRLID  
4.6 x 4.6 x 0.6  
500 PCS / CASE  
CASE DIMS. (in)  
22.8 x 9.8 x 11.6  
1.51 CU.FT.  
11.1 LBS  
TI X HI / 8 X 8



**RECESSED LID**  
PTTESDCRLID-V  
4.6 x 4.6 x 0.6  
500 PCS / CASE  
CASE DIMS. (in)  
22.8 x 9.8 x 11.6  
1.51 CU.FT.  
11.1 LBS  
TI X HI / 8 X 7



# TAMPER EVIDENT 6X6" SQUARE 1, 2, 4 CELL SERIES

Keeps food fresh and separate, helping you to easily separate different foods, ensuring that flavors do not mix, and each food remains fresh.

The lid allows for stable stacking to maximize shelf space.

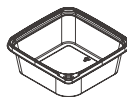

## 24oz

PTTES66-24  
6.1 x 6.1 x 2.2  
300 PCS / CASE  
CASE DIMS. (in)  
19.0 x 12.9 x 15.9  
2.26 CU.FT.  
14.4 LBS  
TI X HI / 7 X 5

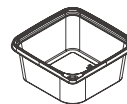

## 32oz

PTTES66-32  
6.1 x 6.1 x 2.8  
300 PCS / CASE  
CASE DIMS. (in)  
19.0 x 12.9 x 16.7  
2.36 CU.FT.  
16.1 LBS  
TI X HI / 7 X 5



## 60oz

PTTES66-60  
6.1 x 6.1 x 5.3  
300 PCS / CASE  
CASE DIMS. (in)  
18.3 x 12.6 x 18.8  
2.50 CU.FT.  
25.4 LBS  
TI X HI / 8 X 5

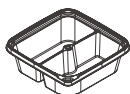

## 2 CELL

9.7oz, 9.8oz  
PTTES66-2C  
6.1 x 6.1 x 2.0  
300 PCS / CASE  
CASE DIMS. (in)  
19.0 x 12.9 x 15.7  
2.22 CU.FT.  
14.4 LBS  
TI X HI / 7 X 5

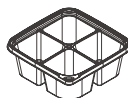

## 4 CELL

5.5oz x 3, 5.1oz  
PTTES66-4C  
6.1 x 6.1 x 2.3  
300 PCS / CASE  
CASE DIMS. (in)  
19.0 x 12.9 x 16.3  
2.30 CU.FT.  
16.1 LBS  
TI X HI / 6 X 5



## RECESSED LID

PTTES66-RLID  
6.0 x 6.0 x 0.3  
300 PCS / CASE  
CASE DIMS. (in)  
17.8 x 12.1 x 14.2  
1.77 CU.FT.  
13.1 LBS  
TI X HI / 8 X 6

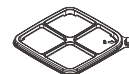

## 4 CELL LID

PTTES66-4CLID  
6.0 x 6.0 x 0.3  
300 PCS / CASE  
CASE DIMS. (in)  
17.8 x 12.1 x 14.2  
1.77 CU.FT.  
13.1 LBS  
TI X HI / 7 X 6

**6.0"**  
152mm Dia.

# RPET HINGED LID DELI CONTAINER



**POST CONSUMER  
RECYCLED PET**

These containers are available in PET, RPET, Blended RPET, and PCR. **\*Prices vary**

One-piece hinged construction and spill-resistant closures. These containers offer enhanced clarity for superior product visibility. Ideal for supermarkets, processors, wholesale clubs, and c-stores.



**4oz**

RPTHLD4  
4.2 x 3.8 x 1.4  
400 PCS / CASE  
CASE DIMS. (in)  
21.7 x 16.1 x 9.4  
1.91 CU.FT.  
11.9 LBS  
TI X HI / 5 X 10



**6oz**

RPTHLD6  
4.2 x 3.8 x 1.9  
400 PCS / CASE  
CASE DIMS. (in)  
22.2 x 16.1 x 9.4  
1.96 CU.FT.  
13.4 LBS  
TI X HI / 5 X 9

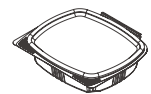

**8oz**

RPTHLD8  
5.6 x 4.9 x 1.4  
200 PCS / CASE  
CASE DIMS. (in)  
17.3 x 10.4 x 12.4  
1.30 CU.FT.  
8.7 LBS  
TI X HI / 9 X 7

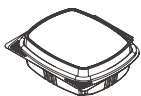

**8oz TALL**

RPTHLD8T  
5.6 x 4.9 x 1.8  
200 PCS / CASE  
CASE DIMS. (in)  
18.9 x 10.4 x 12.4  
1.41 CU.FT.  
9.6 LBS  
TI X HI / 9 X 7

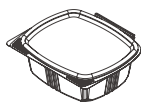

**12oz**

RPTHLD12  
5.6 x 4.9 x 1.9  
200 PCS / CASE  
CASE DIMS. (in)  
17.7 x 10.4 x 12.4  
1.33 CU.FT.  
9.0 LBS  
TI X HI / 9 X 7

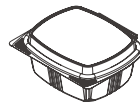

**12oz TALL**

RPTHLD12T  
5.6 x 4.9 x 2.3  
200 PCS / CASE  
CASE DIMS. (in)  
19.3 x 10.4 x 12.4  
1.44 CU.FT.  
9.6 LBS  
TI X HI / 9 X 7

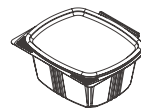

**16oz**

RPTHLD16  
5.6 x 4.9 x 2.5  
200 PCS / CASE  
CASE DIMS. (in)  
20.1 x 10.4 x 12.4  
1.50 CU.FT.  
10.3 LBS  
TI X HI / 8 X 7

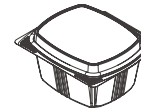

**16oz TALL**

RPTHLD16T  
5.6 x 4.9 x 2.8  
200 PCS / CASE  
CASE DIMS. (in)  
20.1 x 10.4 x 12.4  
1.50 CU.FT.  
11.1 LBS  
TI X HI / 8 X 7

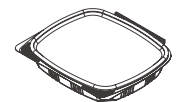

**16oz SHALLOW**

RPTHLD16S  
7.2 x 6.4 x 1.3  
200 PCS / CASE  
CASE DIMS. (in)  
16.7 x 13.8 x 15.4  
2.05 CU.FT.  
16.3 LBS  
TI X HI / 7 X 6

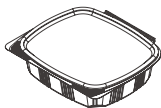

**24oz**

RPTHLD24  
7.2 x 6.4 x 1.9  
200 PCS / CASE  
CASE DIMS. (in)  
18.9 x 13.8 x 15.4  
2.31 CU.FT.  
17.6 LBS  
TI X HI / 7 X 6

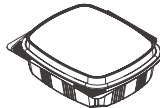

**24oz TALL**

RPTHLD24T  
7.2 x 6.4 x 2.2  
200 PCS / CASE  
CASE DIMS. (in)  
20.5 x 13.8 x 15.4  
2.51 CU.FT.  
19.2 LBS  
TI X HI / 7 X 6

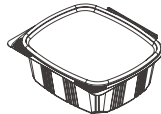

**32oz**

RPTHLD32  
7.2 x 6.4 x 2.6  
200 PCS / CASE  
CASE DIMS. (in)  
20.1 x 13.8 x 15.4  
2.46 CU.FT.  
18.9 LBS  
TI X HI / 7 X 6

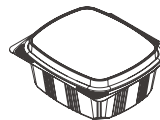

**32oz TALL**

RPTHLD32T  
7.2 x 6.4 x 2.9  
200 PCS / CASE  
CASE DIMS. (in)  
20.1 x 13.8 x 15.4  
2.46 CU.FT.  
18.4 LBS  
TI X HI / 7 X 6

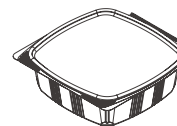

**48oz**

RPTHLD48  
8.0 x 7.9 x 2.5  
200 PCS / CASE  
CASE DIMS. (in)  
19.3 x 16.9 x 16.9  
3.20 CU.FT.  
25.1 LBS  
TI X HI / 4 X 5

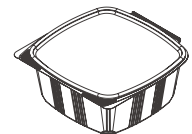

**64oz**

RPTHLD64  
8.0 x 7.9 x 3.3  
200 PCS / CASE  
CASE DIMS. (in)  
22.0 x 16.9 x 16.9  
3.66 CU.FT.  
28.6 LBS  
TI X HI / 4 X 5







# PET CLEAR SALAD BOWLS

Clear PET salad bowls (KODACUP®) deliver durable, crack-resistant performance with premium clarity—ideal for merchandising pre-packed salads and fresh-cut fruit.

The no-spill lid is perfect for stacking. Available in bulk or combo pack, and clear or black bases.

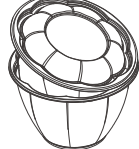

## 175 mm / 6.89" Dia.

					
<b>18oz</b>	<b>24oz</b>	<b>27oz</b>	<b>32oz</b>	<b>48oz</b>	<b>LID</b>
PTSB18-D175	PTSB24-D175	PTSB27-D175AP	PTSB32-D175	PTSB48-D175	PTSBLID-D175AP
6.9 x 2.8	6.9 x 3.2	6.8 x 2.8	6.9 x 4.0	6.9 x 5.2	6.9 x 0.8
150 SETS / CASE	150 SETS / CASE	630 PCS / CASE	150 SETS / CASE	150 SETS / CASE	630 PCS / CASE
CASE DIMS. (in)	CASE DIMS. (in)	CASE DIMS. (in)	CASE DIMS. (in)	CASE DIMS. (in)	CASE DIMS. (in)
21.4 x 7.4 x 22.2	21.4 x 7.4 x 23.0	21.3 x 14.3 x 22.9	21.4 x 7.4 x 23.6	21.4 x 7.4 x 24.4	21.3 x 14.3 x 15.6
2.04 CU.FT.	2.10 CU.FT.	4.03 CU.FT.	2.16 CU.FT.	2.23 CU.FT.	2.72 CU.FT.
9.1 LBS	10.3 LBS	22.3 LBS	12.0 LBS	15.2 LBS	18.9 LBS
TI X HI / 10 X 4	TI X HI / 10 X 4	TI X HI / 7 X 4	TI X HI / 10 X 4	TI X HI / 10 X 4	TI X HI / 7 X 5

## 255 mm / 10.04" Dia.

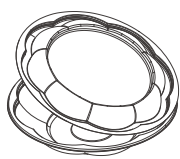
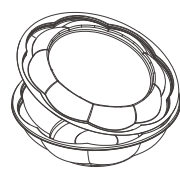
	
<b>40oz</b>	<b>64oz</b>
PTSB40-D255	PTSB64-D255
10.0 x 3.0	10.0 x 3.9
100 SETS / CASE	100 SETS / CASE
CASE DIMS. (in)	CASE DIMS. (in)
20.5 x 10.9 x 15.4	20.5 x 10.9 x 17.5
1.98 CU.FT.	2.25 CU.FT.
13.3 LBS	15.1 LBS
TI X HI / 6 X 6	TI X HI / 6 X 5

# RPET 2-COMPARTMENT CONTAINER WITH 2 SINGLE-COMPARTMENT LIDS

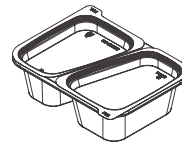

**16oz**  
11.8oz x 2

RP16-2C-LIDC  
7.0 x 5.2 x 2.1  
228 SETS / CASE  
CASE DIMS. (in)  
14.6 x 11.5 x 23.7  
2.32 CU.FT.  
23.6 LBS  
TI X HI / 10 X 3

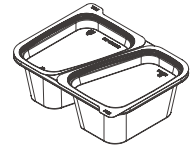

**20oz**  
12.9oz x 2

RP20-2C-LIDC  
7.0 x 5.2 x 2.6  
228 SETS / CASE  
CASE DIMS. (in)  
14.6 x 11.5 x 23.7  
2.32 CU.FT.  
23.6 LBS  
TI X HI / 10 X 3

Keeps foods fresh and separated, preventing flavor transfer and maintaining product integrity.

The lid allows for stable stacking to maximize shelf space.

# PET FILM SEAL CONTAINERS



**4x4"**



**8oz**

PTFS448  
4.4 x 4.4 x 1.6  
960 PCS / CASE  
CASE DIMS. (in)  
22.8 x 13.9 x 22.4  
4.10 CU.FT.  
27.6 LBS  
TI X HI / 6 X 4

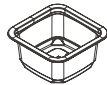

**12oz**

PTFS4412  
4.4 x 4.4 x 2.2  
720PCS / CASE  
CASE DIMS. (in)  
23.0 x 14.1 x 18.0  
3.36 CU.FT.  
23.5 LBS  
TI X HI / 6 X 5

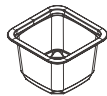

**16oz**

PTFS4416  
4.4 x 4.4 x 2.9  
720 PCS / CASE  
CASE DIMS. (in)  
22.8 x 13.9 x 18.7  
3.41 CU.FT.  
29.2 LBS  
TI X HI / 6 X 4

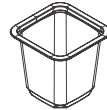

**24oz**

PTFS4424  
4.4 x 4.4 x 4.1  
585 PCS / CASE  
CASE DIMS. (in)  
22.8 x 13.9 x 17.1  
3.12 CU.FT.  
31.9 LBS  
TI X HI / 6 X 5

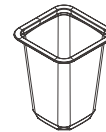

**32oz**

PTFS4432  
4.4 x 4.4 x 5.6  
1000 PCS / CASE  
CASE DIMS. (in)  
23.3 x 18.8 x 20.5  
5.19 CU.FT.  
61.3 LBS  
TI X HI / 4 X 4



**LID**

PTFS44LID  
4.7 x 4.7 x 0.6  
1440 PCS / CASE  
CASE DIMS. (in)  
24.3 x 19.4 x 16.8  
4.59 CU.FT.  
23.8 LBS  
TI X HI / 4 X 5

# 4x6"

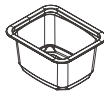

**20oz**  
PTFS4620  
5.4 x 4.4 x 2.9  
540 PCS / CASE  
CASE DIMS. (in)  
16.7 x 13.9 x 22.4  
3.01 CU.FT.  
26.6 LBS  
TI X HI / 7 X 4



**LID**  
PTFS46LID  
5.7 x 4.7 x 0.6  
540PCS / CASE  
CASE DIMS. (in)  
17.6 x 14.7 x 15.1  
2.26 CU.FT.  
12.3 LBS  
TI X HI / 6 X 6

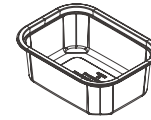

**24oz**  
PTFS56-24  
6.6 x 5.0 x 2.4  
540 PCS / CASE  
CASE DIMS. (in)  
20.5 x 15.6 x 22.2  
4.10 CU.FT.  
28.4 LBS  
TI X HI / 6 X 4

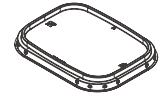

**LID**  
PTFS56LID  
6.9 x 5.3 x 0.5  
540 PCS / CASE  
CASE DIMS. (in)  
21.4 x 16.5 x 12.7  
2.59 CU.FT.  
15.3 LBS  
TI X HI / 5 X 7

# 5x6"



**8oz**  
PTFS08  
5.2 x 4.6 x 1.3  
1140 PCS / CASE  
CASE DIMS. (in)  
21.5 x 14.5 x 17.1  
3.09 CU.FT.  
22.8 LBS  
TI X HI / 5 X 5

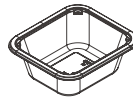

**12oz**  
PTFS12  
5.2 x 4.6 x 1.8  
1140 PCS / CASE  
CASE DIMS. (in)  
21.5 x 14.5 x 17.6  
3.18 CU.FT.  
24.3 LBS  
TI X HI / 5 X 5

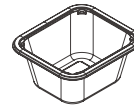

**16oz**  
PTFS16  
5.2 x 4.6 x 2.3  
1140 PCS / CASE  
CASE DIMS. (in)  
21.5 x 14.5 x 17.8  
3.21 CU.FT.  
28.1 LBS  
TI X HI / 5 X 5



**8-16oz LID**  
PTFSSLID  
5.5 x 4.9 x 0.5  
1140 PCS / CASE  
CASE DIMS. (in)  
22.5 x 17.1 x 22.6  
5.03 CU.FT.  
24.3 LBS  
TI X HI / 4 X 4

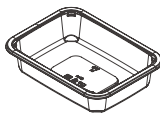

**20oz**  
PTFS20  
7.0 x 5.2 x 1.5  
900 PCS / CASE  
CASE DIMS. (in)  
17.8 x 16.3 x 22.5  
3.78 CU.FT.  
31.4 LBS  
TI X HI / 6 X 4



**24oz**  
PTFS24  
7.0 x 5.2 x 2.0  
900 PCS / CASE  
CASE DIMS. (in)  
18.3 x 16.3 x 22.5  
3.88 CU.FT.  
35.3 LBS  
TI X HI / 6 X 4



**32oz**  
PTFS32  
7.0 x 5.2 x 2.5  
900 PCS / CASE  
CASE DIMS. (in)  
18.8 x 16.3 x 22.5  
3.98 CU.FT.  
35.9 LBS  
TI X HI / 6 X 4



**20-32oz LID**  
PTFSMLID  
7.3 x 5.4 x 0.6  
900 PCS / CASE  
CASE DIMS. (in)  
23.5 x 17.0 x 23.2  
5.36 CU.FT.  
29.0 LBS  
TI X HI / 4 X 3

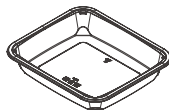

**35oz**  
PTFS35  
7.5 x 8.6 x 1.5  
480 PCS / CASE  
CASE DIMS. (in)  
23.1 x 17.7 x 14.9  
3.52 CU.FT.  
32.1 LBS  
TI X HI / 4 X 6

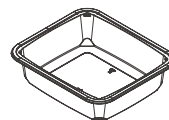

**48oz**  
PTFS48  
7.5 x 8.6 x 2.1  
480 PCS / CASE  
CASE DIMS. (in)  
23.1 x 17.7 x 15.6  
3.68 CU.FT.  
33.2 LBS  
TI X HI / 4 X 5

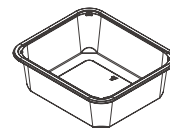

**64oz**  
PTFS64  
7.5 x 8.6 x 2.7  
480 PCS / CASE  
CASE DIMS. (in)  
23.1 x 17.7 x 15.9  
3.75 CU.FT.  
41.2 LBS  
TI X HI / 4 X 5

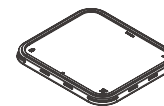

**35-64oz LID**  
PTFSLLID  
8.8 x 7.7 x 0.6  
480 PCS / CASE  
CASE DIMS. (in)  
19.5 x 16.1 x 27.4  
4.96 CU.FT.  
34.4 LBS  
TI X HI / 6 X 3



# LEAFY GREENS



## 4.5oz

PTFS50Z  
 8.9 x 7.0 x 3.4  
 432 PCS / CASE  
 CASE DIMS. (in)  
 22.0 x 18.6 x 18.5  
 4.37 CU.FT.  
 32.2 LBS  
 TIX HI / 4 X 5

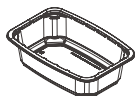

## 9.5oz

PTFS950Z  
 11.8 x 8.1 x 3.1  
 237 PCS / CASE  
 CASE DIMS. (in)  
 24.9 x 12.4 x 22.6  
 4.02 CU.FT.  
 29.9 LBS  
 TIX HI / 6 X 4

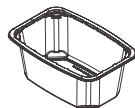

## 1LB

PTFS1LB  
 11.8 x 8.1 x 4.8  
 216 PCS / CASE  
 CASE DIMS. (in)  
 24.6 x 12.1 x 21.8  
 3.74 CU.FT.  
 32.9 LBS  
 TIX HI / 6 X 4

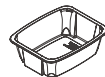

## PTFSPGP5

9.0 x 7.2 x 2.8  
 352 PCS / CASE  
 CASE DIMS. (in)  
 18.7 x 15.2 x 27.5  
 4.53 CU.FT.  
 24.1LBS  
 TIX HI / 6 X 3

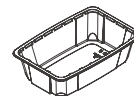

## PTFSPGP9.5

12.3 x 8.1 x 3.2  
 261 PCS / CASE  
 CASE DIMS. (in)  
 25.0 x 12.9 x 27.2  
 5.07 CU.FT.  
 36.2 LBS  
 TIX HI / 6 X 3

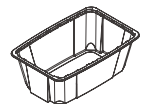

## PTFSPGP16

12.3 x 8.1 x 4.3  
 249 PCS / CASE  
 CASE DIMS. (in)  
 25.0 x 12.9 x 27.2  
 5.08 CU.FT.  
 35.5 LBS  
 TIX HI / 6 X 3



# PET BUTTER LETTUCE SINGLE & DOUBLE HINGED CONTAINERS

This container offers superb clarity and protection of the product.

Well suited for processors & green house packers.

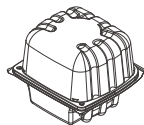

PTHBLC-1  
7.3 x 6.6 x 5.7  
270 PCS / CASE  
CASE DIMS. (in)  
23.8 x 15.7 x 13.9  
3.01 CU.FT.  
26.1 LBS  
TI X HI / 5 X 6

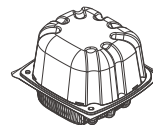

PTHBLC-1-TB  
7.3 x 6.6 x 5.7  
270 PCS / CASE  
CASE DIMS. (in)  
23.8 x 15.7 x 13.9  
3.01 CU.FT.  
24.9 LBS  
TI X HI / 5 X 6

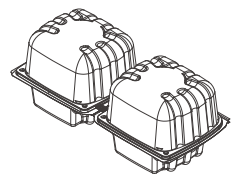

PTHBLC-2  
15.0 x 6.5 x 5.7  
135 PCS / CASE  
CASE DIMS. (in)  
23.8 x 15.7 x 13.9  
3.01 CU.FT.  
26.1 LBS  
TI X HI / 5 X 6



# PLATTERS

THE FIRST TAMPER-EVIDENT CATERING TRAYS IN THE INDUSTRY. AVAILABLE IN 10.7", 12", 14", AND 16" SIZES.



**10.7"**

Tamper Evident

PTTE107CT2-C  
11.0 x 11.0 x 1.8  
96 SETS / CASE  
CASE DIMS. (in)  
22.7 x 20.9 x 12.0  
3.31 CU.FT.  
25.3 LBS  
TI X HI / 4 X 7



**10.7"**

Tamper Evident

PTTE107CT3-C  
11.0 x 11.0 x 3.0  
90 SETS / CASE  
CASE DIMS. (in)  
22.7 x 20.9 x 12.0  
3.31 CU.FT.  
25.8 LBS  
TI X HI / 4 X 7

COMING SOON



**12"**

PTTE12CTB  
12.2 x 12.2 x 3.5  
86 SETS / CASE  
CASE DIMS. (in)  
24.9 x 18.2 x 13.2  
3.46 CU.FT.  
31.6 LBS  
TI X HI / 4 X 6



**14"**

PTTE14CT-C  
14.2 x 14.2 x 4.5  
51 SETS / CASE  
CASE DIMS. (in)  
22.4 x 15.2 x 15.5  
3.04 CU.FT.  
25.6 LBS  
TI X HI / 5 X 6



**16"**

PTTE16CT-C  
16.1 x 16.1 x 4.5  
35 SETS / CASE  
CASE DIMS. (in)  
18.5 x 16.7 x 17.5  
3.14 CU.FT.  
25.0 LBS  
TI X HI / 6 X 5

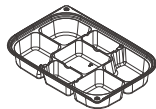

**7 CELL TRAY**

13.6oz, 13.2oz x 2, 11.7oz x 2, 6.1oz x 2

PTTE913-7C  
13.8 x 10.6 x 2.1  
100 PCS / CASE  
CASE DIMS. (in)  
20.4 x 14.4 x 17.9  
3.04 CU.FT.  
16.7 LBS  
TI X HI / 5 X 5

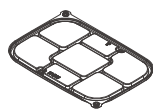

**7 CELL TRAY  
VENTED LID**

PTTE913-7CLID-V  
13.8 x 10.6 x 0.4  
100 PCS / CASE  
CASE DIMS. (in)  
19.8 x 14.4 x 16.5  
2.72 CU.FT.  
16.1 LBS  
TI X HI / 6 X 5



# PET CAKE & BAKERY CONTAINERS



KODACUP branded Cake & Bakery Container with clear dome lids are a perfect fit for 6-10" cakes and pies.



Easy to label on the side of the cake dome.

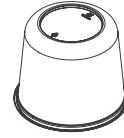

## 6" PETITE

PTCC6  
6.3 x 8.1 x 6.2  
100 SETS / CASE  
CASE DIMS. (in)  
31.5 x 16.1 x 8.9  
2.61 CU.FT.  
18.8 LBS  
TI X HI / 3 X 10

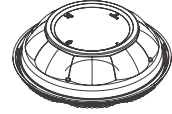

## 9" PIE

PTPC9SL  
6.0 x 10.2 x 3.9  
110 SETS / CASE  
CASE DIMS. (in)  
25.2 x 20.9 x 10.6  
3.23 CU.FT.  
20.3 LBS  
TI X HI / 2 X 8

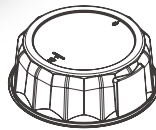

## 8" SINGLE

NFPTCC8SL  
9.2 x 10.4 x 3.6  
100 SETS / CASE  
CASE DIMS. (in)  
24.4 x 20.9 x 11.2  
3.31 CU.FT.  
23.2 LBS  
TI X HI / 2 X 7

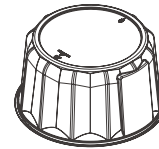

## 8" DOUBLE

NFPTCC8DL  
8.9 x 10.4 x 5.5  
100 SETS / CASE  
CASE DIMS. (in)  
24.4 x 20.9 x 11.2  
3.31 CU.FT.  
24.1 LBS  
TI X HI / 2 X 7

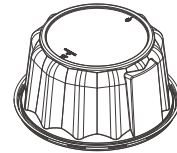

## 10" DOUBLE

PTCC10DL  
7.7 x 11.2 x 5.5  
50 SETS / CASE  
CASE DIMS. (in)  
22.0 x 17.5 x 12.0  
2.68 CU.FT.  
15.2 LBS  
TI X HI / 4 X 7

## PET STRAWBERRY LONG BAR CAKE CONTAINER

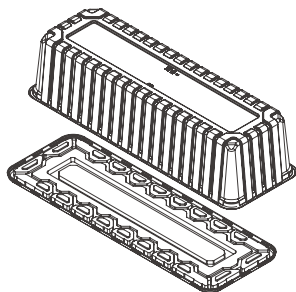

SBCL-B500  
20.8 x 7.1 x 5.0  
25 SETS / CASE  
CASE DIMS. (in)  
23.3 x 21.9 x 8.3  
2.44 CU.FT.  
13.1 LBS  
TI X HI / 4 X 10

## PET 3-COMPARTMENT COOKIES CONTAINER

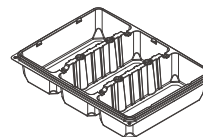

60oz  
PT1082-3C  
10.5 x 7.8 x 2.2  
162 PCS / CASE  
CASE DIMS. (in)  
24.2 x 11.3 x 15.1  
2.38 CU.FT.  
19.2 LBS  
TI X HI / 8 X 6

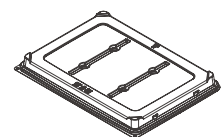

DOME LID  
PT108DLID  
10.5 x 7.8 x 0.9  
162 PCS / CASE  
CASE DIMS. (in)  
24.2 x 11.3 x 13.8  
2.18 CU.FT.  
11.9 LBS  
TI X HI / 8 X 8

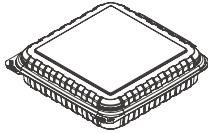

BHC70-225R  
 9.4 x 8.9 x 2.2  
 232 PCS / CASE  
 CASE DIMS. (in)  
 38.0 x 9.8 x 21.9  
 4.69 CU.FT.  
 28.8 LBS  
 T I X H I / 5 X 4

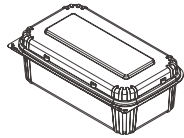

BHC35  
 9.0 x 5.3 x 3.2  
 100 PCS / CASE  
 CASE DIMS. (in)  
 18.5 x 11.3 x 14.8  
 1.80 CU.FT.  
 9.9 LBS  
 T I X H I / 8 X 6

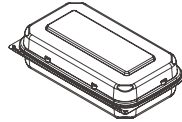

BHC35-225  
 9.0 x 5.3 x 2.5  
 280 PCS / CASE  
 CASE DIMS. (in)  
 22.8 x 18.9 x 18.2  
 4.54 CU.FT.  
 23.9 LBS  
 T I X H I / 4 X 5



BHC35-275  
 9.0 x 5.2 x 2.8  
 320 PCS / CASE  
 CASE DIMS. (in)  
 22.1 x 18.5 x 17.7  
 4.19 CU.FT.  
 31.8 LBS  
 T I X H I / 4 X 5



BHCDB95  
 13.4 x 5.6 x 2.7  
 65 PCS / CASE  
 CASE DIMS. (in)  
 14.2 x 14.0 x 17.9  
 2.05 CU.FT.  
 9.73 LBS  
 T I X H I / 9 X 5

## PET BAKERY HINGED CONTAINER

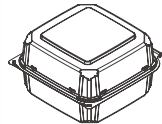

PTH66  
 5.7 x 5.5 x 3.1  
 356 SETS / CASE  
 CASE DIMS. (in)  
 22.9 x 13.4 x 12.3  
 2.19 CU.FT.  
 17.4 LBS  
 T I X H I / 6 X 7

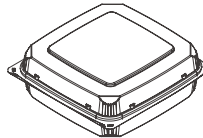

PTH88  
 8.2 x 8.0 x 2.8  
 300 SETS / CASE  
 CASE DIMS. (in)  
 23.7 x 16.9 x 16.9  
 3.92 CU.FT.  
 31.2 LBS  
 T I X H I / 4 X 5

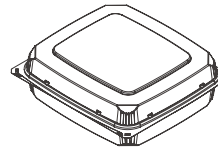

PTH98  
 9.1 x 8.3 x 2.8  
 164 SETS / CASE  
 CASE DIMS. (in)  
 18.8 x 13.4 x 17.6  
 2.57 CU.FT.  
 21.7 LBS  
 T I X H I / 7 X 5

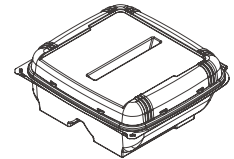

PTHSJC  
 9.1 x 8.4 x 3.5  
 100 SETS / CASE  
 CASE DIMS. (in)  
 22.8 x 17.2 x 10.1  
 2.30 CU.FT.  
 13.9 LBS  
 T I X H I / 4 X 9

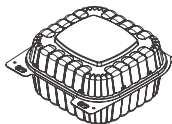

PTHDB66XL  
 5.9 x 5.9 x 2.8  
 320 PCS / CASE  
 CASE DIMS. (in)  
 25.0 x 13.4 x 13.0  
 2.52 CU.FT.  
 14.5 LBS  
 T I X H I / 6 X 7

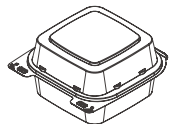

PTHDB66XLSW  
 5.9 x 5.9 x 3.1  
 400 PCS / CASE  
 CASE DIMS. (in)  
 24.8 x 19.6 x 12.8  
 3.60 CU.FT.  
 24.2 LBS  
 T I X H I / 4 X 7



# PET CLEAR ROUND DELI CONTAINERS

KODACUP branded PET clear Round Deli containers are perfect for high quality in store presentation.

Stackable containers offer maximum shelf space utilization.



**8oz**

PTRDC08  
4.6 x 3.8 x 1.6  
500 PCS / CASE  
CASE DIMS. (in)  
23.6 x 9.8 x 13.4  
1.80 CU.FT.  
11.4 LBS  
TI X HI / 8 X 6



**12oz**

PTRDC12  
4.6 x 3.7 x 2.4  
500 PCS / CASE  
CASE DIMS. (in)  
23.6 x 9.8 x 13.6  
1.83 CU.FT.  
14.8 LBS  
TI X HI / 8 X 6

**HEAVY WEIGHT**



**12oz**

PTRDC12H  
4.6 x 3.7 x 2.4  
500 PCS / CASE  
CASE DIMS. (in)  
23.6 x 9.8 x 13.6  
1.83 CU.FT.  
22.1 LBS  
TI X HI / 8 X 6



**16oz**

PTRDC16  
4.6 x 3.6 x 3.0  
500 PCS / CASE  
CASE DIMS. (in)  
23.6 x 9.8 x 14.4  
1.93 CU.FT.  
19.3 LBS  
TI X HI / 8 X 6

**HEAVY WEIGHT**



**16oz**

PTRDC16H  
4.6 x 3.6 x 3.0  
500 PCS / CASE  
CASE DIMS. (in)  
23.6 x 9.8 x 14.4  
1.93 CU.FT.  
22.1 LBS  
TI X HI / 8 X 6



**24oz**

PTRDC24  
4.6 x 3.4 x 4.3  
500 PCS / CASE  
CASE DIMS. (in)  
23.6 x 9.8 x 16.1  
2.17 CU.FT.  
22.6 LBS  
TI X HI / 8 X 5

**HEAVY WEIGHT**



**24oz**

PTRDC24H  
4.6 x 3.4 x 4.3  
500 PCS / CASE  
CASE DIMS. (in)  
23.6 x 9.8 x 16.1  
2.17 CU.FT.  
22.1 LBS  
TI X HI / 8 X 5



**32oz**

PTRDC32  
4.6 x 3.2 x 5.6  
500 PCS / CASE  
CASE DIMS. (in)  
23.6 x 9.8 x 19.3  
2.59 CU.FT.  
25.2 LBS  
TI X HI / 8 X 4



**SNACK CUP**

DR-SC-DL  
4.6 x 2.7 x 4.8  
250 SETS / CASE  
CASE DIMS. (in)  
22.4 x 15.0 x 10.2  
1.98 CU.FT.  
12.3 LBS  
TI X HI / 5 X 9



**DOME LID**

PTRDCDOME  
4.7 x 1.8  
500 PCS / CASE  
CASE DIMS. (in)  
24.8 x 9.8 x 8.9  
1.25 CU.FT.  
10.4 LBS  
TI X HI / 8 X 9



**OVERCAP LID**

PTRDCLIDOUT  
4.7 x 0.5  
500 PCS / CASE  
CASE DIMS. (in)  
24.8 x 9.8 x 9.4  
1.33 CU.FT.  
6.9 LBS  
TI X HI / 8 X 9



**RECESSED LID**

PTRDCLIDIN  
4.8 x 0.3  
500 PCS / CASE  
CASE DIMS. (in)  
24.8 x 9.8 x 9.4  
1.33 CU.FT.  
7.1 LBS  
TI X HI / 8 X 9

# PET CLEAR CUPS & LIDS



**92 mm / 3.62" Dia.**



## 9oz FILM SEAL

PTC09FS-D92  
3.6 x 2.2 x 2.9  
1,000 PCS / CASE  
CASE DIMS. (in)  
18.7 x 15.2 x 15.2  
2.50 CU.FT.  
22.2 LBS  
TI X HI / 6 X 5



## 9oz SMOOTH WALL

PTC09SW-D92  
3.6 x 2.2 x 2.8  
1,000 PCS / CASE  
CASE DIMS. (in)  
18.7 x 15.2 x 13.7  
2.26 CU.FT.  
22.2 LBS  
TI X HI / 6 X 6



## 12oz TALL

PTC12-D92  
3.6 x 2.4 x 4.2  
1,000 PCS / CASE  
CASE DIMS. (in)  
18.7 x 15.2 x 17.1  
2.82 CU.FT.  
27.6 LBS  
TI X HI / 6 X 5



## 16oz

PTC16-D92  
3.6 x 2.4 x 4.9  
1,000 PCS / CASE  
CASE DIMS. (in)  
18.7 x 15.2 x 21.5  
3.53 CU.FT.  
31.4 LBS  
TI X HI / 6 X 4



## 20oz

PTC20-D92  
3.6 x 2.6 x 5.8  
1,000 PCS / CASE  
CASE DIMS. (in)  
18.7 x 15.2 x 16.9  
2.79 CU.FT.  
39.0 LBS  
TI X HI / 6 X 5



## 4oz INSERT

PTINS-D92  
3.6 x 2.6 x 1.0  
1,000 PCS / CASE  
CASE DIMS. (in)  
19.3 x 8.4 x 10.0  
0.94 CU.FT.  
7.7 LBS  
TI X HI / 10 X 9



## 4oz INSERT

PTINS-D92-DEEP  
3.6 x 2.5 x 1.3  
1,000 PCS / CASE  
CASE DIMS. (in)  
19.3 x 8.4 x 10.8  
1.02 CU.FT.  
7.7 LBS  
TI X HI / 10 X 8



## NO SLOT

PTLID-F92NS  
3.6 x 0.4  
1,000 PCS / CASE  
CASE DIMS. (in)  
19.1 x 15.6 x 8.3  
1.42 CU.FT.  
6.8 LBS  
TI X HI / 6 X 10



## STRAW SLOT

PTLID-F92SS  
3.6 x 0.4  
1,000 PCS / CASE  
CASE DIMS. (in)  
19.1 x 15.6 x 8.3  
1.42 CU.FT.  
6.8 LBS  
TI X HI / 6 X 9



## NO SLOT w/TAB

PTLID-F92NS-T  
3.6 x 0.4  
1,000 PCS / CASE  
CASE DIMS. (in)  
19.7 x 16.0 x 10.3  
1.88 CU.FT.  
8.3 LBS  
TI X HI / 6 X 9



## FILM SEAL

PTLID-92FS  
3.9 x 0.5  
1,000 PCS / CASE  
CASE DIMS. (in)  
20.2 x 16.3 x 10.8  
20.6 CU.FT.  
11.0 LBS  
TI X HI / 5 X 8



## NO HOLE

PTLID-D92NH  
3.6 x 1.8  
1,000 PCS / CASE  
CASE DIMS. (in)  
19.5 x 16.7 x 8.3  
1.56 CU.FT.  
9.5 LBS  
TI X HI / 10 X 4



## SQUARE NO HOLE

PTLID-D92SDNH  
3.6 x 1.6  
1,000 PCS / CASE  
CASE DIMS. (in)  
20.5 x 18.5 x 8.7  
1.90 CU.FT.  
11.8 LBS  
TI X HI / 4 X 10



## ROUND HOLE

PTLID-D92RH  
3.6 x 1.8  
1,000 PCS / CASE  
CASE DIMS. (in)  
19.5 x 16.7 x 8.3  
1.56 CU.FT.  
9.5 LBS  
TI X HI / 4 X 11



## WIDE HOLE

PTLID-D92WH  
3.6 x 1.5  
1,000 PCS / CASE  
CASE DIMS. (in)  
19.5 x 18.1 x 8.3  
1.69 CU.FT.  
9.9 LBS  
TI X HI / 4 X 10

# 98 mm / 3.86" Dia.



## 12/14oz

PTC14-D98  
3.9 x 2.2 x 4.0  
1,000 PCS / CASE  
CASE DIMS. (in)  
19.9 x 15.9 x 14.8  
2.70 CU.FT.  
29.5 LBS  
TI X HI / 6 X 6



## 16/18oz

PTC16-D98  
3.9 x 2.5 x 4.7  
1,000 PCS / CASE  
CASE DIMS. (in)  
19.9 x 15.9 x 15.0  
2.74 CU.FT.  
34.6 LBS  
TI X HI / 6 X 5



## 20oz

PTC20-D98  
3.9 x 2.3 x 5.4  
1,000 PCS / CASE  
CASE DIMS. (in)  
19.9 x 15.9 x 16.5  
3.02 CU.FT.  
38.4 LBS  
TI X HI / 6 X 5



## 24oz

PTC24-D98  
3.9 x 2.4 x 5.9  
600 PCS / CASE  
CASE DIMS. (in)  
15.7 x 11.8 x 18.9  
2.03 CU.FT.  
24.7 LBS  
TI X HI / 10 X 4



## 4oz INSERT

PTINS-D98  
3.9 x 3.0 x 1.3  
1,000 PCS / CASE  
CASE DIMS. (in)  
20.1 x 8.5 x 12.8  
1.26 CU.FT.  
9.4 LBS  
TI X HI / 9 X 7



## NO SLOT

PTLID-F98NS  
3.9 x 0.4  
1,000 PCS / CASE  
CASE DIMS. (in)  
20.9 x 17.0 x 8.3  
1.72 CU.FT.  
8.9 LBS  
TI X HI / 4 X 10



## STRAW SLOT

PTLID-F98SS  
3.9 x 0.4  
1,000 PCS / CASE  
CASE DIMS. (in)  
20.9 x 17.0 x 8.3  
1.72 CU.FT.  
9.0 LBS  
TI X HI / 4 X 10



## STRAWLESS SIP LID

PTLID-S98  
3.9 x 0.9  
1,000 PCS / CASE  
CASE DIMS. (in)  
20.9 x 16.8 x 9.3  
1.87 CU.FT.  
9.6 LBS  
TI X HI / 4 X 10



## NO HOLE

PTLID-D98NH  
3.9 x 1.8  
1,000 PCS / CASE  
CASE DIMS. (in)  
20.7 x 17.5 x 8.9  
1.86 CU.FT.  
11.7 LBS  
TI X HI / 4 X 10



## ROUND HOLE

PTLID-D98RH  
3.9 x 1.8  
1,000 PCS / CASE  
CASE DIMS. (in)  
20.7 x 17.5 x 8.9  
1.86 CU.FT.  
11.7 LBS  
TI X HI / 4 X 10



## WIDE HOLE

PTLID-D98WH  
3.9 x 1.6  
1,000 PCS / CASE  
CASE DIMS. (in)  
20.7 x 17.5 x 8.9  
1.86 CU.FT.  
11.7 LBS  
TI X HI / 4 X 10



# 78 mm / 3.07" Dia.



## 7oz

PTC07-D78  
3.1 x 1.9 x 3.2  
1,000 PCS / CASE  
CASE DIMS. (in)  
15.7 x 12.6 x 13.0  
1.49 CU.FT.  
17.5 LBS  
TI X HI / 9 X 7



## 8oz

PTC08-D78  
3.1 x 2.1 x 3.2  
1,000 PCS / CASE  
CASE DIMS. (in)  
15.7 x 12.6 x 16.5  
1.90 CU.FT.  
16.2 LBS  
TI X HI / 9 X 5



## 10oz

PTC10-D78  
3.1 x 2.0 x 4.0  
1,000 PCS / CASE  
CASE DIMS. (in)  
15.7 x 12.6 x 17.3  
1.99 CU.FT.  
17.8 LBS  
TI X HI / 9 X 5



## STRAW SLOT

PTLID-F78SS  
3.1 x 0.3  
2,000 PCS / CASE  
CASE DIMS. (in)  
16.3 x 13.6 x 13.4  
1.72 CU.FT.  
8.8 LBS  
TI X HI / 9 X 7



## ROUND HOLE

PTLID-D78RH  
3.1 x 1.5  
2,000 PCS / CASE  
CASE DIMS. (in)  
17.3 x 16.1 x 13.0  
2.10 CU.FT.  
11.9 LBS  
TI X HI / 4 X 7



# 107 mm / 4.21" Dia.



## 32oz

PTC32-D107  
4.2 x 2.9 x 6.9  
500 PCS / CASE  
CASE DIMS. (in)  
22.2 x 17.9 x 16.9  
3.90 CU.FT.  
32.8 LBS  
TI X HI / 4 X 5



## STRAW SLOT

PTLID-F107SS  
4.2 x 0.4  
500 PCS / CASE  
CASE DIMS. (in)  
22.0 x 9.4 x 9.4  
1.14 CU.FT.  
4.8 LBS  
TI X HI / 8 X 9



## STRAW SLOT

PTLID-D107SS  
4.2 x 1.7  
500 PCS / CASE  
CASE DIMS. (in)  
23.2 x 9.4 x 11.8  
1.50 CU.FT.  
6.9 LBS  
TI X HI / 8 X 7



## ROUND HOLE

PTLID-D107RH  
4.2 x 1.7  
500 PCS / CASE  
CASE DIMS. (in)  
23.2 x 9.4 x 11.8  
1.50 CU.FT.  
6.9 LBS  
TI X HI / 8 X 8

# PLA BIOPLASTIC CLEAR CUPS & LIDS

STORE IN A COOL PLACE. IDEAL BEVERAGE TEMPERATURE: 14°F (-10°C) TO 104°F (40°C).

## 92 mm / 3.62" Dia.



### 9oz SQUAT

PLAC09SW-D92  
3.6 x 2.4 x 2.8  
1,000 PCS / CASE  
CASE DIMS. (in)  
18.7 x 15.2 x 13.8  
2.27 CU.FT.  
22.2 LBS  
TI X HI / 6 X 6



### 12oz TALL

PLAC12-D92  
3.6 x 2.3 x 4.2  
1,000 PCS / CASE  
CASE DIMS. (in)  
18.7 x 15.2 x 14.8  
2.43 CU.FT.  
25.0 LBS  
TI X HI / 6 X 6



### ROUND HOLE

PLALID-D92RH  
3.6 x 1.8  
1,000 PCS / CASE  
CASE DIMS. (in)  
19.5 x 18.1 x 8.3  
1.69 CU.FT.  
9.1 LBS  
TI X HI / 4 X 11



### STRAW SLOT

PLALID-F92SS  
3.6 x 0.4  
1,000 PCS / CASE  
CASE DIMS. (in)  
19.1 x 15.6 x 8.3  
1.42 CU.FT.  
6.8 LBS  
TI X HI / 6 X 9



## 96 mm / 3.78" Dia.



### 9oz

PLAC09SW-D96  
3.8 x 2.2 x 3.1  
1,000 PCS / CASE  
CASE DIMS. (in)  
19.8 x 15.9 x 13.8  
2.52 CU.FT.  
19.5 LBS  
TI X HI / 6 X 6



### 12/14oz

PLAC12-D96  
3.8 x 2.1 x 4.2  
1,000 PCS / CASE  
CASE DIMS. (in)  
19.8 x 15.9 x 15.2  
2.77 CU.FT.  
25.8 LBS  
TI X HI / 6 X 5



### 16/18oz

PLAC16-D96  
3.8 x 2.4 x 4.9  
1,000 PCS / CASE  
CASE DIMS. (in)  
19.8 x 15.9 x 21.7  
3.95 CU.FT.  
30.8 LBS  
TI X HI / 6 X 4



### 20oz

PLAC20-D96  
3.8 x 2.4 x 5.5  
1,000 PCS / CASE  
CASE DIMS. (in)  
19.8 x 15.9 x 24.0  
4.38 CU.FT.  
30.4 LBS  
TI X HI / 6 X 3



### 24oz

PLAC24-D96  
3.8 x 2.5 x 6.0  
1,000 PCS / CASE  
CASE DIMS. (in)  
19.8 x 15.9 x 25.6  
4.67 CU.FT.  
34.4 LBS  
TI X HI / 6 X 3



### STRAW SLOT

PLALID-F96SS  
3.8 x 0.4  
1,000 PCS / CASE  
CASE DIMS. (in)  
20.2 x 17.0 x 8.4  
1.68 CU.FT.  
8.3 LBS  
TI X HI / 4 X 11

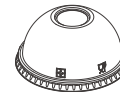

### ROUND HOLE

PLALID-D96RH  
3.8 x 1.8  
1,000 PCS / CASE  
CASE DIMS. (in)  
20.3 x 16.4 x 10.4  
2.01 CU.FT.  
10.3 LBS  
TI X HI / 4 X 8

STORE IN A COOL PLACE. IDEAL BEVERAGE TEMPERATURE: 14°F (-10°C) TO 104°F (40°C).

## 98 mm / 3.86" Dia.



### 12/14oz

PLAC14-D98  
3.9 x 2.2 x 4.0  
1,000 PCS / CASE  
CASE DIMS. (in)  
19.9 x 15.9 x 14.8  
2.70 CU.FT.  
28.6 LBS  
TI X HI / 6 X 6



### 16/18oz

PLAC16-D98  
3.9 x 2.5 x 4.7  
1,000 PCS / CASE  
CASE DIMS. (in)  
20.0 x 15.9 x 14.6  
2.69 CU.FT.  
30.6 LBS  
TI X HI / 5 X 6



### 20oz

PLAC20-D98  
3.9 x 2.4 x 5.4  
1,000 PCS / CASE  
CASE DIMS. (in)  
19.9 x 15.9 x 16.5  
3.02 CU.FT.  
35.6 LBS  
TI X HI / 5 X 5



### 24oz

PLAC24-D98  
3.9 x 2.4 x 5.9  
600 PCS / CASE  
CASE DIMS. (in)  
15.7 x 11.8 x 18.9  
2.03 CU.FT.  
22.3 LBS  
TI X HI / 10 X 4



### STRAW SLOT

PLALID-F98SS  
3.9 x 0.4  
1,000 PCS / CASE  
CASE DIMS. (in)  
20.9 x 17.0 x 9.1  
1.88 CU.FT.  
8.3 LBS  
TI X HI / 4 X 9

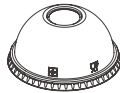

### ROUND HOLE

PLALID-D98RH  
3.9 x 1.8  
1,000 PCS / CASE  
CASE DIMS. (in)  
20.7 x 19.3 x 9.1  
2.09 CU.FT.  
10.8 LBS  
TI X HI / 4 X 9

## 107 mm / 4.21" Dia.



### 32oz

PLAC32-D107  
4.2 x 3.0 x 6.9  
500 PCS / CASE  
CASE DIMS. (in)  
22.2 x 17.9 x 16.9  
3.90 CU.FT.  
31.1 LBS  
TI X HI / 4 X 5



### STRAW SLOT

PLALID-F107SS  
4.2 x 0.4  
500 PCS / CASE  
CASE DIMS. (in)  
22.0 x 9.4 x 9.4  
1.14 CU.FT.  
5.1 LBS  
TI X HI / 8 X 9





# CUSTOM PRINTING

GET YOUR MESSAGE DIRECTLY INTO THE HANDS OF YOUR CUSTOMERS.

Custom printing is the perfect solution to build your brand image and grow market awareness. It allows you to cost effectively advertise your company's brand - products, style and values - and provides a point of distinction for your brand in an otherwise saturated market. It is a portable billboard for your business right in your customers hands. It's an advantage that what we like to call "Brand In Hand".

Customize all your foodservice disposables – plastic drink cups and plastic round deli containers.



EASILY & EFFECTIVELY  
PROMOTE YOUR BUSINESS

## WE UNDERSTAND PRINTING



### PRINTING APPLICATION

We have world-class printing equipment. For plastic cups and containers, we have four 6-color Van Dam UV offset printing machines.

### PRINTING SERVICE

We manage all design and print services in-house. We can recreate or modify your existing artwork or our designers can help you develop an entirely new brand concept. We can even create mock-ups so that you can see what the actual product will look like once artwork is finalized.

# 5 STEPS

**SIMPLE & EASY!**

# WE'RE HERE TO HELP

WHATEVER YOUR PRINTING NEEDS

01

Choose the cup or container size(s) you need. We offer a wide range of sizes on PET drink cups, PLA drink cups, and PET round deli containers.

02

Choose up to 6-colors for your plastic cups / containers, and up to 4-colors for your customized PLA drink cups.

03

Send us your artwork as an AI (Adobe Illustrator), EPS (Encapsulated PostScript) or PDF file. If electronic artwork is not available, send a sample of your cup or container and we will recreate the artwork by hand.

04

Once you have perfected your design, we will produce a digital file of the artwork for you to review and approve. We can also create a mock-up, if needed, for a minimal charge.

05

The printing process begins once the digital artwork file and/or mock-up has been approved and purchase order has been received. Custom printed products will be produced and delivered within our stated normal lead times.

**Our minimum order quantity for most custom prints is 50,000 pieces per sku.**

## ARTWORK REQUIREMENTS



### FILE FORMAT ▶ .AI

- Shapes and fonts must be outlined.
- Font size must be at least 8 pt bold.
- Artwork elements must be in layers, not merged.
- All images embedded and must be at least 300 dpi or higher.
- Define all colors CMYK or PANTONE® Solid Coated / Uncoated Color Code.
- PANTONE® Solid Coated Colors can be used, but not all colors can be achieved.



If your artwork is designed by Photoshop or Corel Draw, please save it as a high resolution PDF, AI, or EPS file.



BEVERAGE & FOOD  
PACKAGING SOLUTIONS  
TO MEET YOUR NEEDS

[WWW.EATERYESSENTIALS.COM](http://WWW.EATERYESSENTIALS.COM)

**P** (469) 482-9066      **F** (801) 742-5398

Physical: 2425 W Danieldale Rd., Dallas, TX 75237

Mailing Address: PO Box 593 Desoto, TX 75123